

DOWNTOWN

INFOCUS

A BLUEPRINT FOR FARGO'S CORE



January 27 & 28, 2017
Open House!

welcome to the second
open house!



DOWNTOWN @ 
INFOCUS 
F R S T I V A L
JANUARY 27 & 28

your chance to warm up & weigh in on initial ideas for the future



What is
Downtown
InFocus?

DOWNTOWN INFOCUS

A BLUEPRINT FOR FARGO'S CORE

Downtown InFocus is a comprehensive and open planning process to envision the future of Downtown Fargo. All members of the public are invited to help shape this plan for Fargo's Core and to take action to help its implementation. **WE HOPE YOU'LL GET INVOLVED!**

ONLINE @
www.fargoinfofocus.org

Purpose of the plan

Create a blueprint for Downtown to guide redevelopment and investments in infrastructure and the public realm.

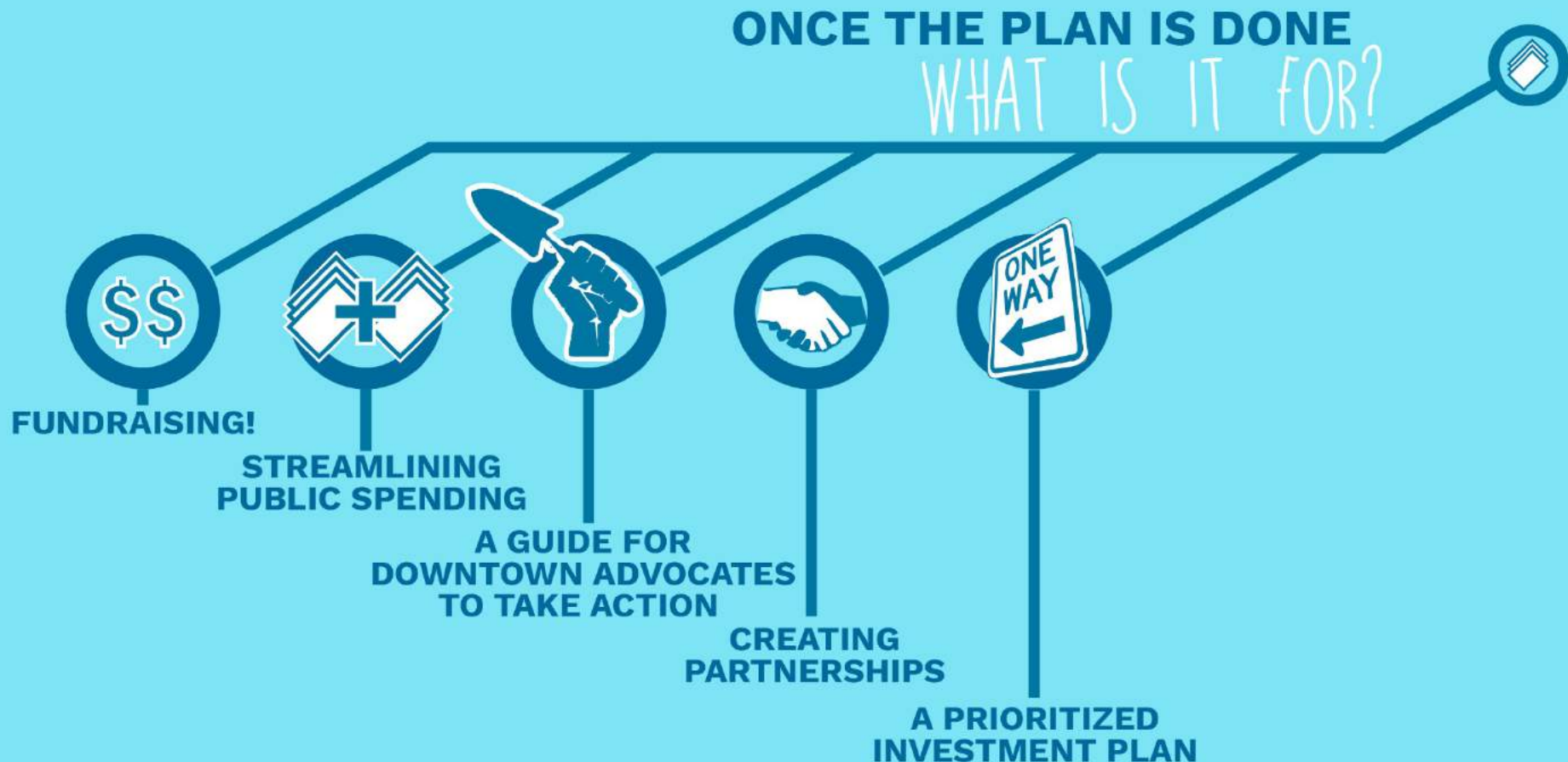



Here is where we are “focused.” It’s what many refer to as Downtown – 560 acres in the heart of Fargo. Downtown does not exist in a vacuum, of course, so think of these boundaries as very fuzzy.

The Focus Area

Source: Interface Studio

-  **RAIL**
-  **OPEN SPACE**
-  **DOWNTOWN FOCUS AREA**



So far, you have shared lots of ideas for Downtown. This open house is designed to talk about those ideas. First, let's quickly recap the last time we all got together...

THANKS to the 280 PEOPLE

who joined us in October



OPEN HOUSE No. 1

at The Historic Union, 1026 NP Ave

You came from all over the region

SHOW US
➤ where you live

32% of attendees
identified
themselves as
**“from
Downtown”**





we collected your **OBSERVATIONS** and **IDEAS**
for Downtown on the **COLLABORATIVE MAP**



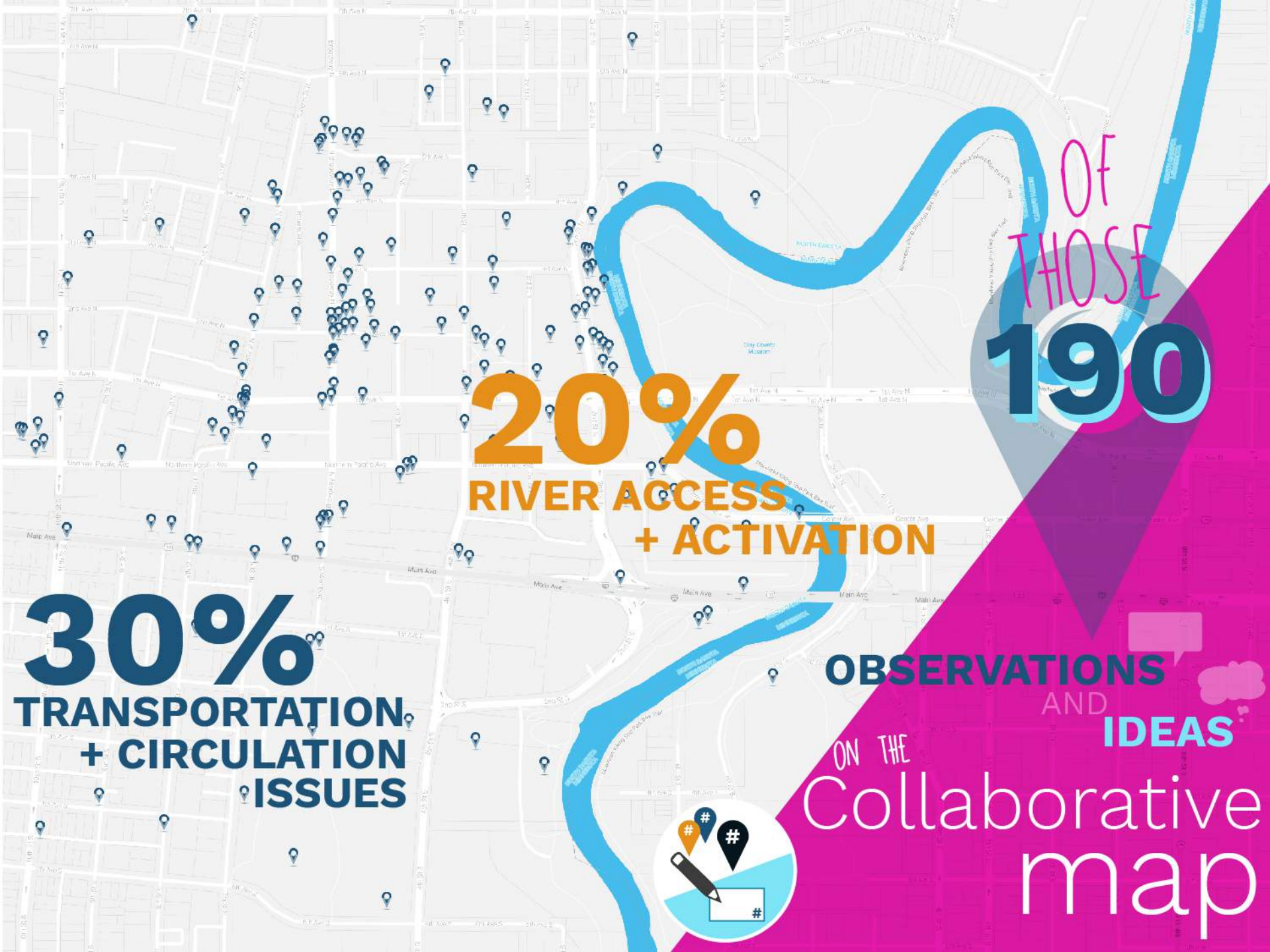

OF THOSE
190

20%
**RIVER ACCESS
+ ACTIVATION**

30%
**TRANSPORTATION
+ CIRCULATION
ISSUES**

**OBSERVATIONS
AND
IDEAS**
ON THE
**Collaborative
map**





we received **519 COMPLETED SURVEYS**
from people who **LIVE** or **WORK** Downtown

(some people took the survey online)

1) WRITE IT ON THE CHALKBOARD
2) SELECT A PROP OR TWO
3) SMILE FOR THE CAMERA WITH YOUR **BIG IDEA!**



we invited your

BIG IDEAS

you wrote us postcards from the FUTURE

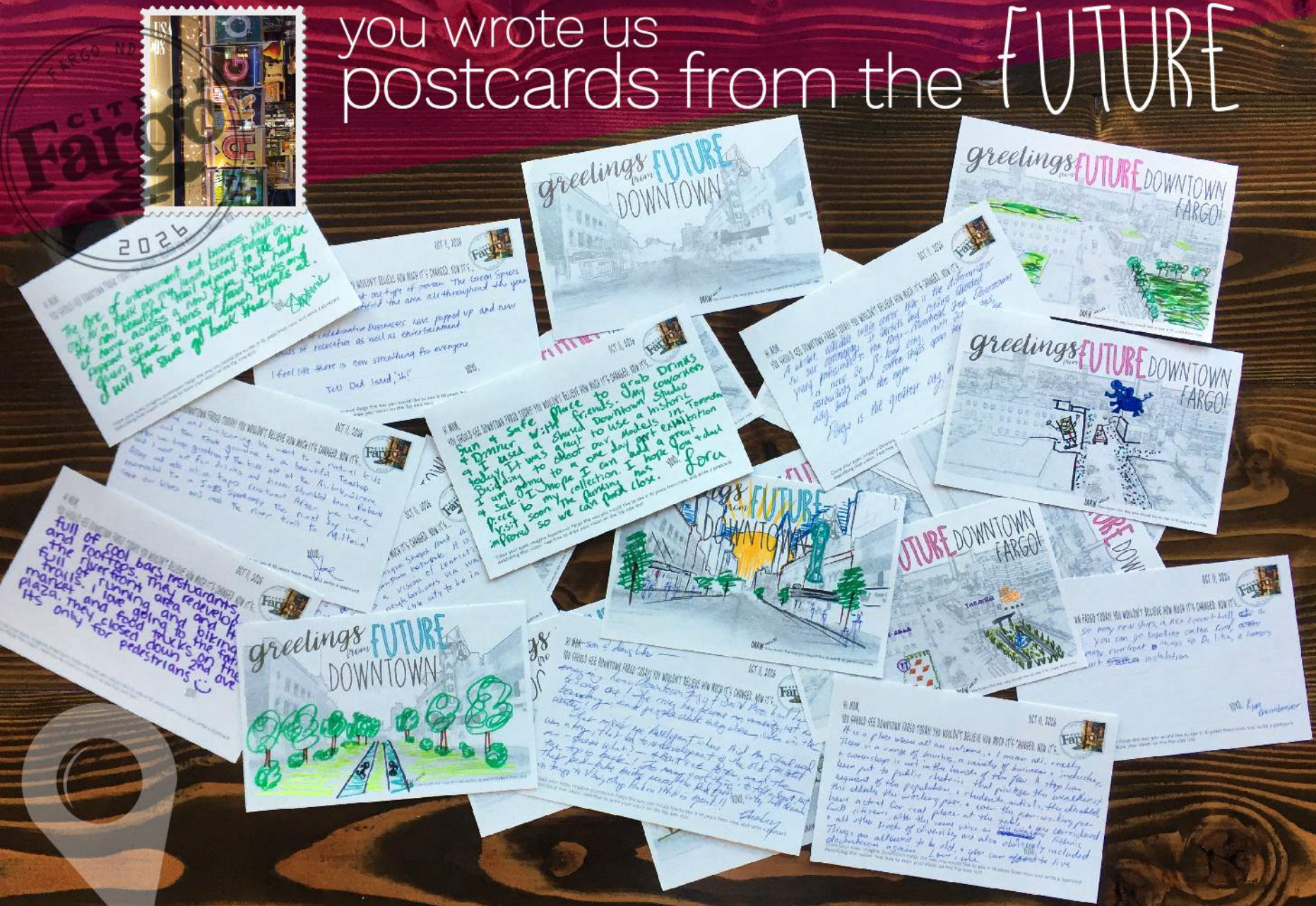

VISION STATEMENTS IN YOUR OWN WORDS



HI MOM,

YOU SHOULD SEE DOWNTOWN FARGO TODAY! YOU WOULDN'T BELIEVE HOW MUCH IT'S CHANGED. NOW IT'S...

“...a perfect mix of **old and new**. Retro, modern, classic, and edgy.”

“...there is **family space** for play and exercise. It has great, green activities everywhere we gather. It is safe, and affordable.”

“...**diverse** and includes lots of different cultures. It's where you come to get culture.”

“There are 100,000 people living downtown, and not just college kids, but **all ages and incomes**. There's even a bunch of old people like Dad! I'm still riding my bike to work, but now it's safer because the City reconstructed **roads to balance the needs of all users**. Most parking lots have been converted back to buildings, but no one complains about having to walk farther because there is so much going on that it's an enjoyable experience.”

“It's **even more vibrant!** There are community events every weekend, and awesome out door **activities year round**. Downtown has some great food trucks, cafes, and plenty of green space to enjoy!”

“It's a **magnet for innovators and artists**.”

“... It's **more walkable than ever**. The city of Fargo also expanded the trails and created access from downtown... I can **do pretty much everything** downtown even shop for groceries! The only time I really have to leave is for work. I love it!”

“... a **must see** of the Midwest!”

“...Inviting streets are filled with pedestrians walking to and from all the shops and restaurants. The **lush tree canopy and stormwater gardens** bring life to the sidewalks.... I can't wait till winter when the ice trails open!”

A HANDFUL OF
VISION STATEMENTS



we merged your words:

DOWNTOWN FARGO IS a **family-friendly destination** offering a **variety of experiences** that are **welcoming to all – a must-see of the Midwest.**

We retain our **diverse** mix of Downtown residents and businesses and cultivate local jobs by becoming a **magnet for innovators** and a **place where great ideas are demonstrated.**

Our streets are **walkable, green,** and **vibrant,** and new multi-use **trails connect Downtown to the Red River** and beyond.

As a creative center, Downtown offers **big-city amenities** and talent within a **small-town atmosphere.**

We welcome new buildings but also value preservation, resulting in a Downtown that is the **perfect mix of old and new...classic and modern.**

is the collective vision on point?
what are you most focused on?



I'm focused on a Downtown that is:

grab a card and strike a pose

**BIG CITY
YET
SMALL TOWN**

**FULL OF
VARIETY**

*family-
friendly*

*classic &
MODERN*

**A
DESTINATION**

*a place of
ideas + action*

**WELCOMING
to
ALL**

*a magnet
for
innovators*

**α MUST-SEE
of the
MIDWEST**

**WRITE IN
YOUR OWN!**

*walkable,
green,
vibrant*

*connected
to the
river*

To achieve this vision,
we started thinking
about different
scenarios for
Downtown



WHAT IF?

we **expanded** the
population **living**
downtown?

...to help support more retail and services and improve the
perceptions of safety Downtown

Some initial ideas:

Focus on transitions by developing new housing types that better help to transition from Downtown to the neighborhoods and keep in mind, Downtown does not currently offer a wide range of housing types.

Integrate affordability by creating new affordable and workforce housing to maintain a diverse population base.

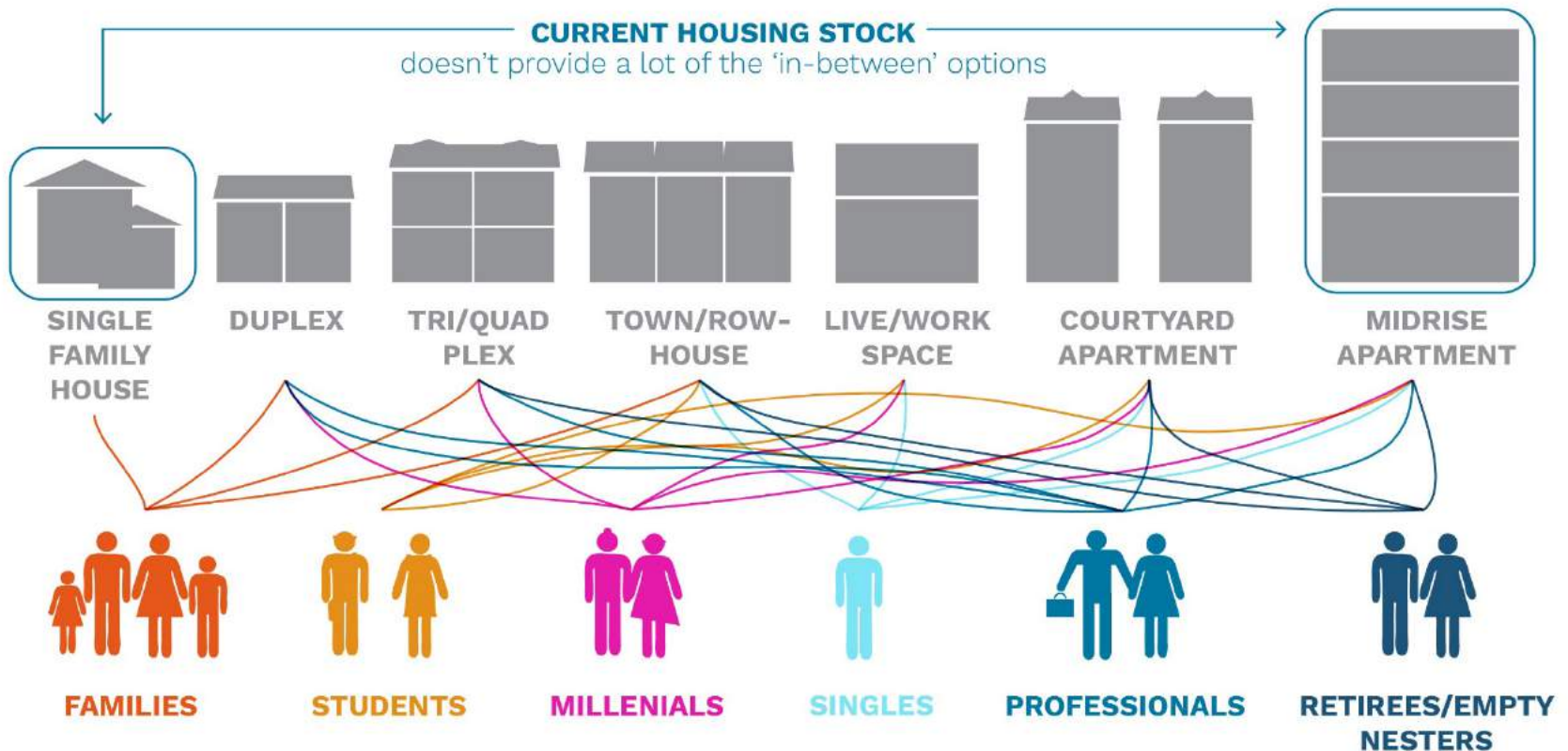

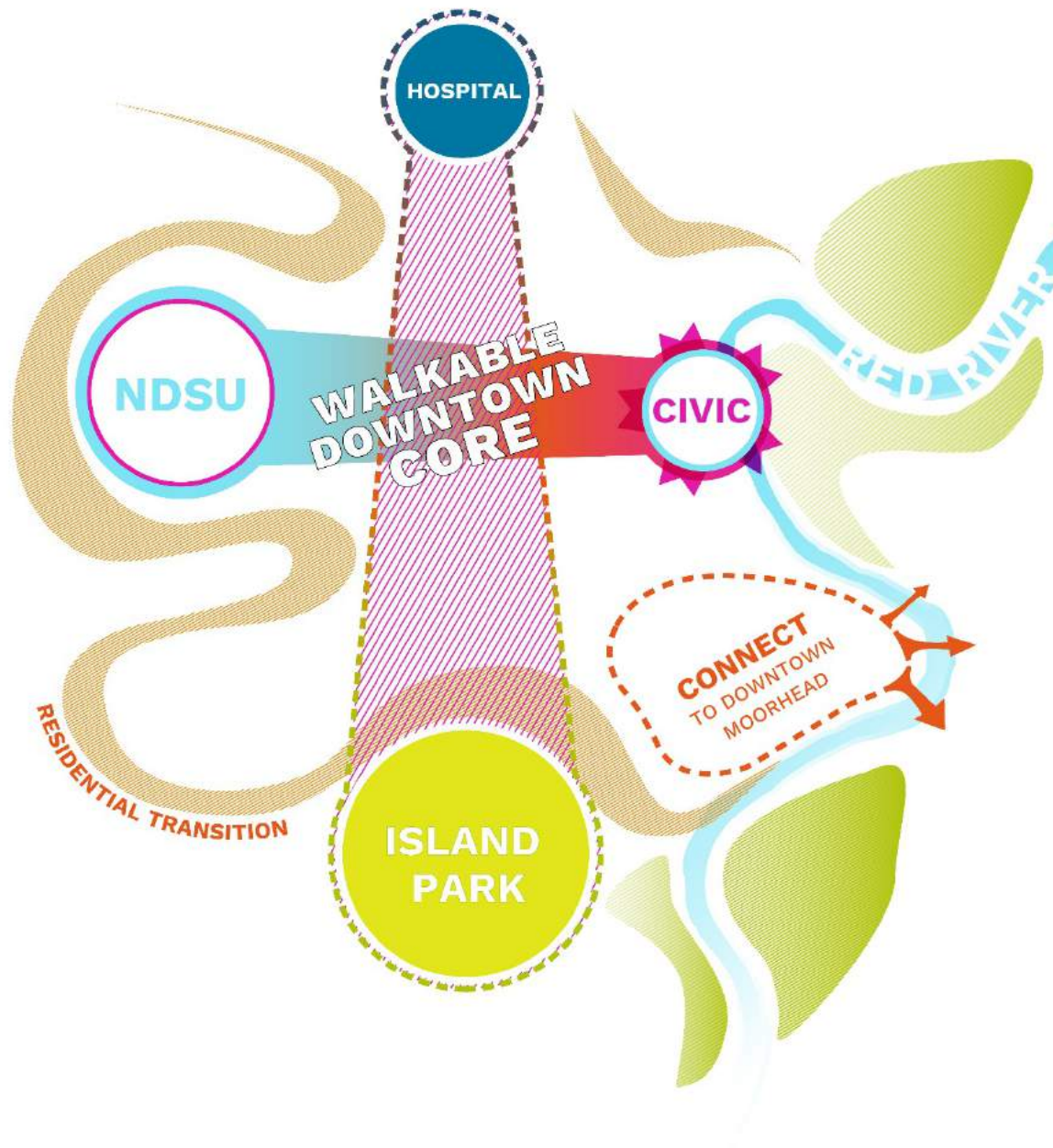

Where could new and different types of housing go? We think there are opportunities to bring the nearby neighborhoods closer to Downtown's core but also better connect to Downtown Moorhead

Work toward reusing existing buildings and encouraging new development on empty land and land used only for surface parking. Looking forward, how should these properties be reused?

Opportunity Sites

Source: Interface Studio

UNDERUTILIZED LAND

-  PUBLICLY OWNED
-  PRIVATELY OWNED
- SURFACE PARKING LOTS**
-  PUBLICLY OWNED
-  PRIVATELY OWNED
-  RIVER ACCESS POINT
-  FLOOD PROTECTION LINE
-  FUTURE DEVELOPMENT [COMING SOON]
-  OPEN SPACE
-  DOWNTOWN FOCUS AREA

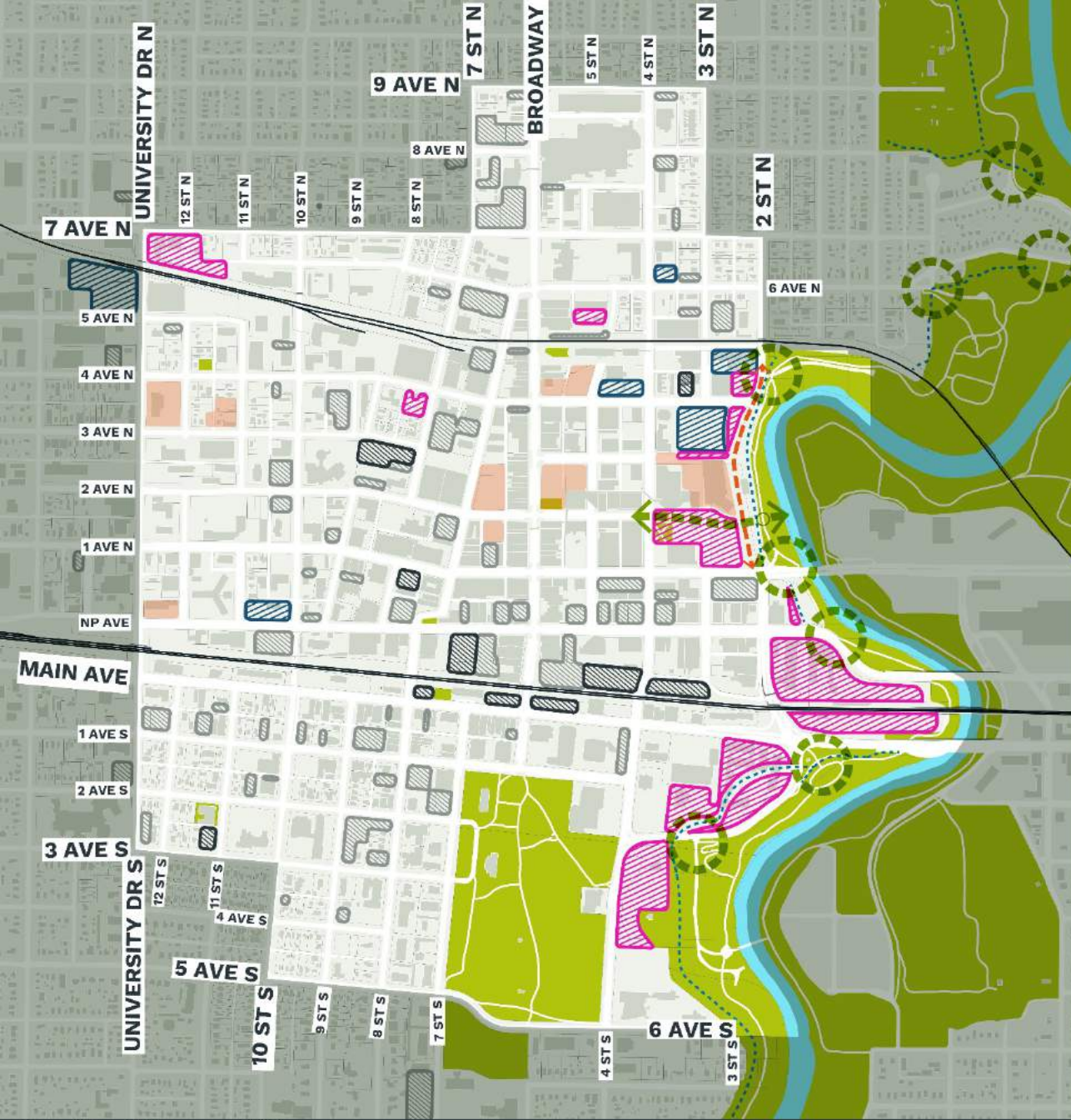

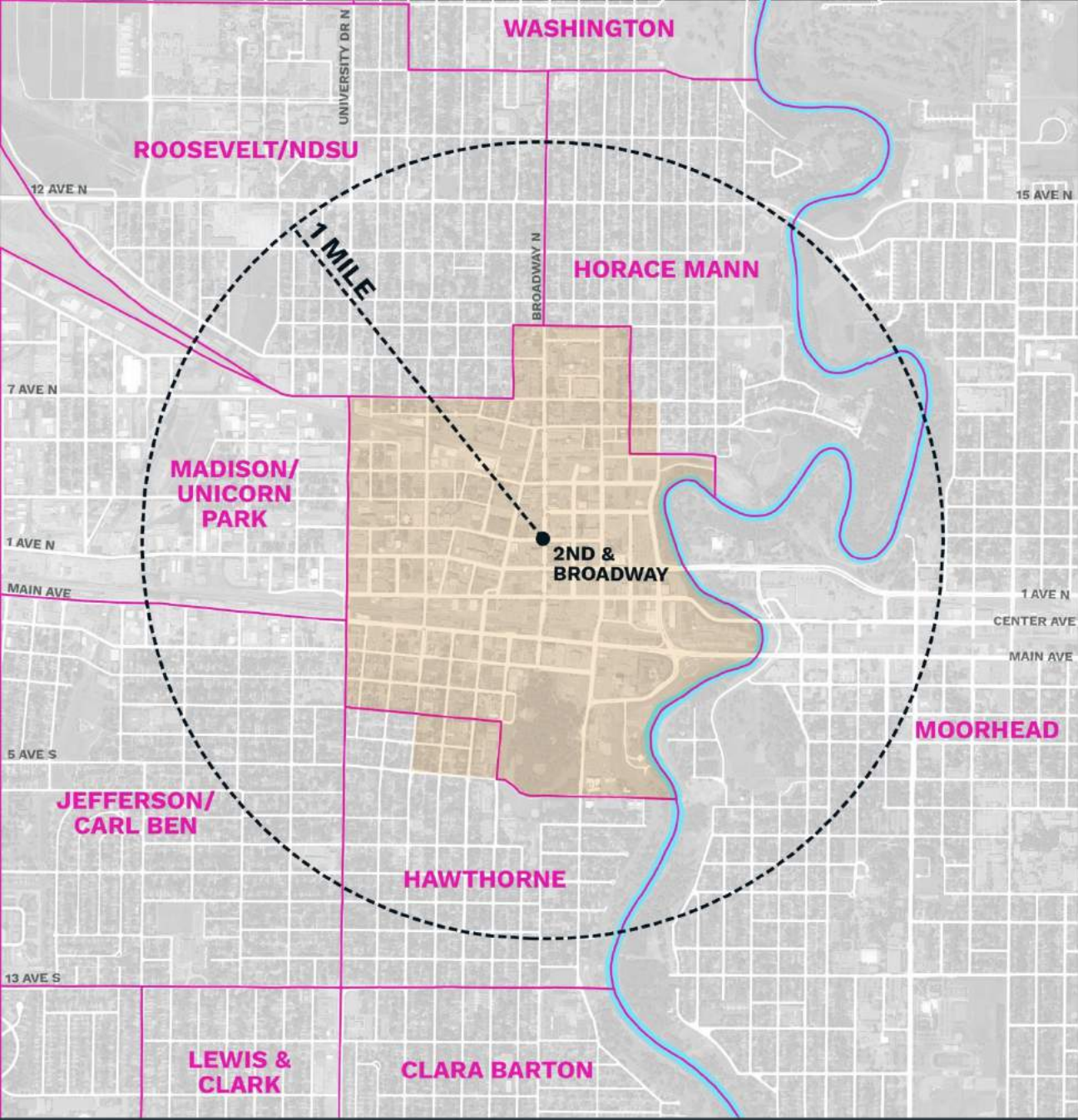

But, it is equally important to **encourage investment in the near-neighborhoods** by creating better street connections and use of the City's housing rehabilitation efforts near downtown.

Near Neighborhoods

Source: Interface Studio

- NEIGHBORHOOD BOUNDARY
- DOWNTOWN FOCUS AREA



Some initial ideas:

Finally, if Downtown is to become more of a neighborhood, we have to **address concerns and perceptions about safety.** We should look to improve lighting, support efforts of neighbors and businesses to clamp down on nuisance activity, and market Downtown as one of Fargo's safest and most diverse neighborhoods

INFORUM

Search Q

FAMILY Ford Fog/Mist and Breezy WEATHER 36°

STOP IN TODAY!

logitech

MK320 Wireless Combo 50% OFF

THIS WEEK ONLY! \$19.99

STAR Make Ma

Downtown Fargo residents fed up with alcohol-driven crime

By Adrian Glass-Moore on Jan 27, 2016 at 10:34 p.m.



INFORUM

Search Q

FAMILY Ford Fog/Mist and Breezy WEATHER 36°

News Sports Opinion SheSays Variety Business Milestones Obituaries Weather

Serious assaults rising in downtown Fargo, with 60 last year

By Archie Ingersoll on Jan 14, 2017 at 8:10 p.m.



PRINT

Bundles of Joy FORUM ADVERTISING FEATURES

INCLUDE YOUR BABY IN THIS KEEP SAKE SECTION! DEADLINE JAN 20. ONLINE SUBMISSIONS ONLY - CLICK HERE

VIEW ALL OFFERS | SUBSCRIBE | ADD YOUR BUSINESS

LATEST

- 34 apply to become next Cass County administrator 7 min ago
- Sen. Franken voting 'no' on education secretary nominee 26 min ago
- Executive actions ready to go as Trump prepares to take office 38 min ago

because **you told us**

“it’s not just about more people Downtown... we need more jobs & commerce too!”





WHAT IF?

we **increased** the number,
and type, of **jobs**
downtown (and accessible
from downtown)?

...by supporting existing retailers, ensuring space is available for new businesses and retaining more students after graduation

Some initial ideas:

Support our existing retail through marketing Downtown here and beyond and

Help fill new commercial spaces and support locally-owned retail by helping to recruit new businesses and assisting them with their launch.

Pursue selective alley development to better make use of the older, narrower and deep buildings. These spaces can be an attractive “front door” for retail.

THAT SOUNDS GREAT...
BUT HOW CAN WE
DO IT?



Let's also focus on attracting and retaining talent by :

Creating a pipeline of job opportunities for NDSU graduates.

Identify possible internship and co-op programs to increase access of students to entry-level jobs in and near Downtown.

And, for those working outside of Downtown but living here, **provide enhanced bus service to industrial parks.**



because **you told us**

We need more street life! Downtown's thrive because they offer a unique experience





WHAT IF?

downtown found new ways
to encourage **creativity**,
bring people together and
celebrate the arts?

...to create a unique Downtown experience

THAT SOUNDS GREAT...
BUT HOW CAN WE
DO IT?

Some initial ideas:

First, we could consider **deregulating to loosen the restrictions** for outdoor dining, food trucks, parklets and other temporary uses uses to support local businesses



Parklets



Temporary sidewalk



Foodtrucks

THAT SOUNDS GREAT...
BUT HOW CAN WE
DO IT?

Some initial ideas:

Push to change the liquor laws because dining outside with a glass of wine is a privilege every Downtown outside of North Dakota can offer. But we should also better **manage our events Downtown** by relieving pressure on Broadway and permitting events in other designated areas



Further, we need a **Downtown events calendar** to better promote what is happening when

105
49

JUST LAST YEAR...
SPECIAL EVENTS WERE HELD IN FARGO
OF THEM WERE HOSTED IN DOWNTOWN

● BLOCK PARTY! ● FESTIVAL / FAIR ● PARADE ● 5/10K RUN/WALK/BIKE ● EVENT

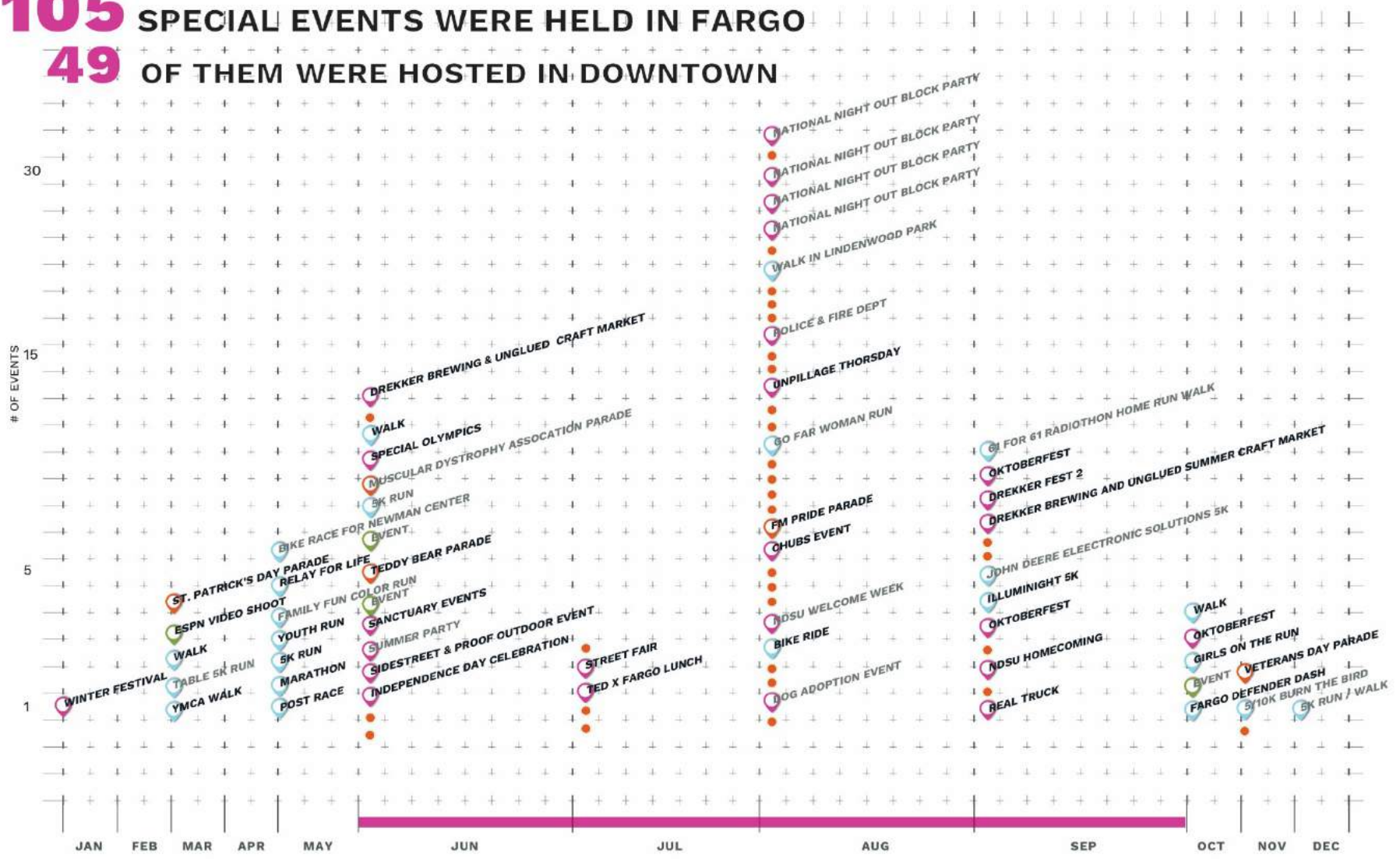



What about the arts?

Expand the footprint of the arts by encouraging new public art within new development and as public expressions of Fargo's identity.

To keep Downtown unique, we also need to **protect collaborative workspace Downtown** at a price artists and cultural organizations can afford.

We should also **Pursue the Performing Arts Center** to reinforce Downtown as THE center for arts and talent

Most people don't know how many arts and creative businesses are Downtown. **What if we branded and promoted a design district Downtown?**

Arts & Cultural Assets

Source: Interface Studio, City of Fargo

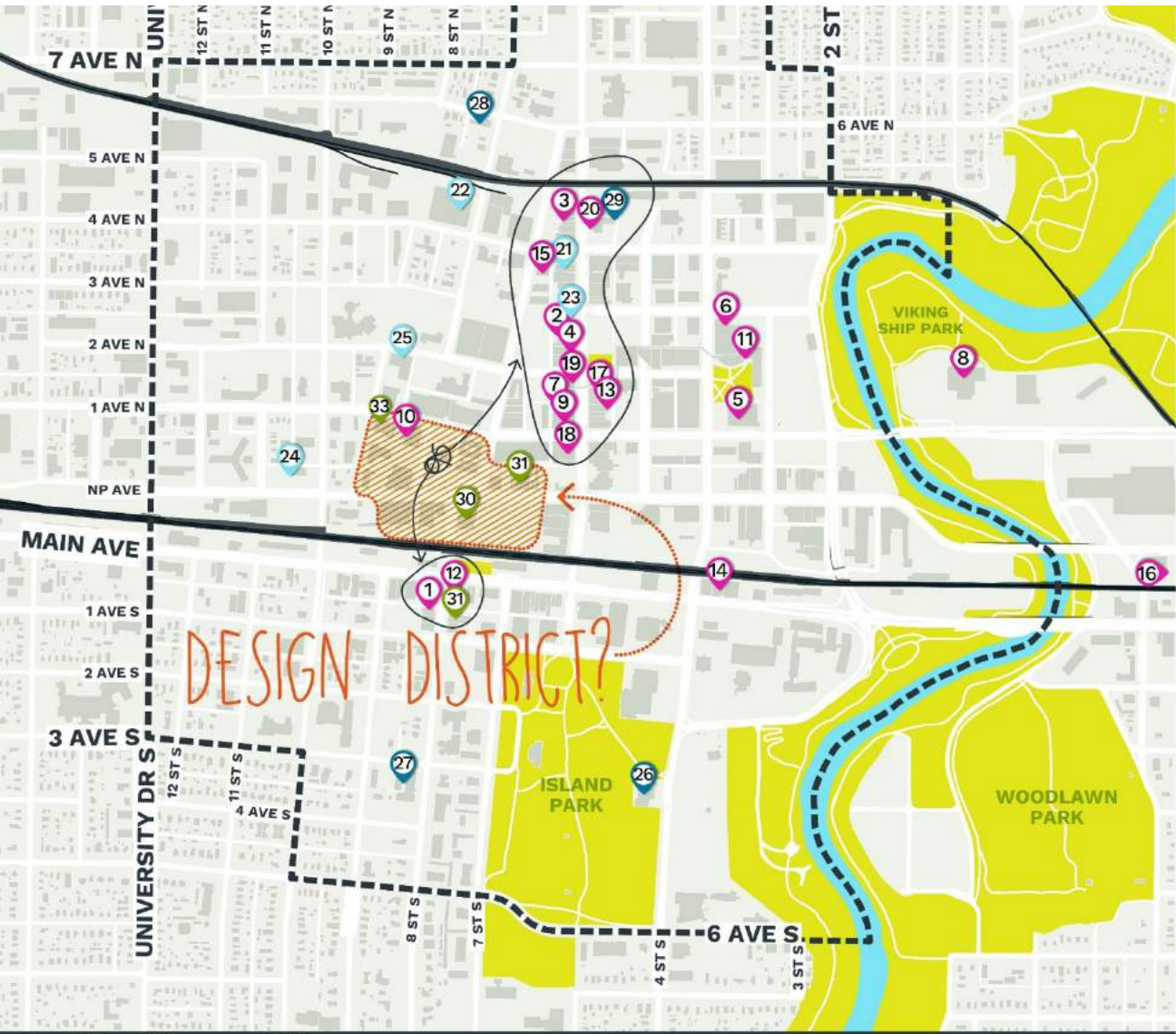

- MUSEUMS & GALLERIES**
 - 1 8th Street Art Gallery
 - 2 Boerth's Gallery and Design Studio
 - 3 C.Lizzy's
 - 4 Ecce Gallery
 - 5 Fargo Public Library
 - 6 Fargo Civic Memorial Auditorium
 - 7 Gallery 4
 - 8 Hjemkomst Interpretive Center
 - 9 Parallel Galleries
 - 10 Plains Art Museum
 - 11 Public Art Exhibit at City Hall
 - 12 Rando Art Studio
 - 13 River Cities Literary Arts Center
 - 14 Riverzen Art Studio & Salon
 - 15 Roberts Street Chapel
 - 16 Rourke Art Museum
 - 17 Spirit Room
 - 18 The Uptown Gallery
 - 19 The Whipped Stitch
 - 20 Revland Gallery

- ATTRACTIONS & ENTERTAINMENT**
 - 21 The Fargo Theatre
 - 22 Sanctuary Events Center
 - 23 The Aquarium
 - 24 Nestor Tavern
 - 25 Sons of Norway

- PERFORMING ARTS**
 - 26 Fargo Moorhead Community Theatre
 - 27 Fargo Moorhead Symphony
 - 28 F-M Ballet
 - 29 Theatre B

- DESIGN SCHOOLS**
 - 30 NDSU Department of Architecture
 - 31 Josef's School of Hair Design
 - 32 Moler Barber College of Hairstyling
 - 33 Katherine Kilbourne Burgum Center for Creativity

- DOWNTOWN FOCUS AREA**



At the last open house, you told us what Downtown needs.

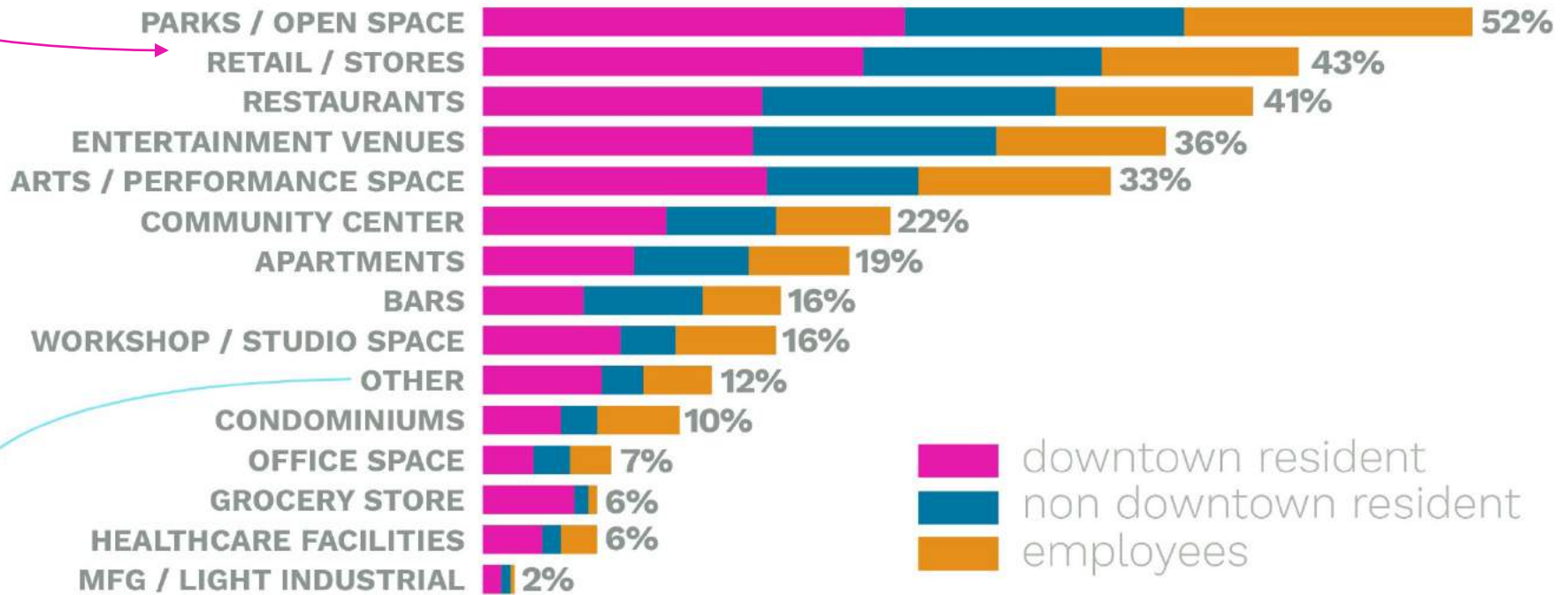

AFFORDABLE APARTMENTS, HOTEL, MINI TARGET, GYM, PARKING, DAY TO DAY ITEMS

Now, what should go where?

WHAT WE WANT YOU TO DO...

Help us decide where to focus different types of development. Take a strip of stickers and place them on the various opportunity sites Downtown:

**MIXED USE/
COMMERCIAL**



**PUBLIC/CIVIC/
INSTITUTIONAL**



RESIDENTIAL



**PARKS/
OPEN SPACE**

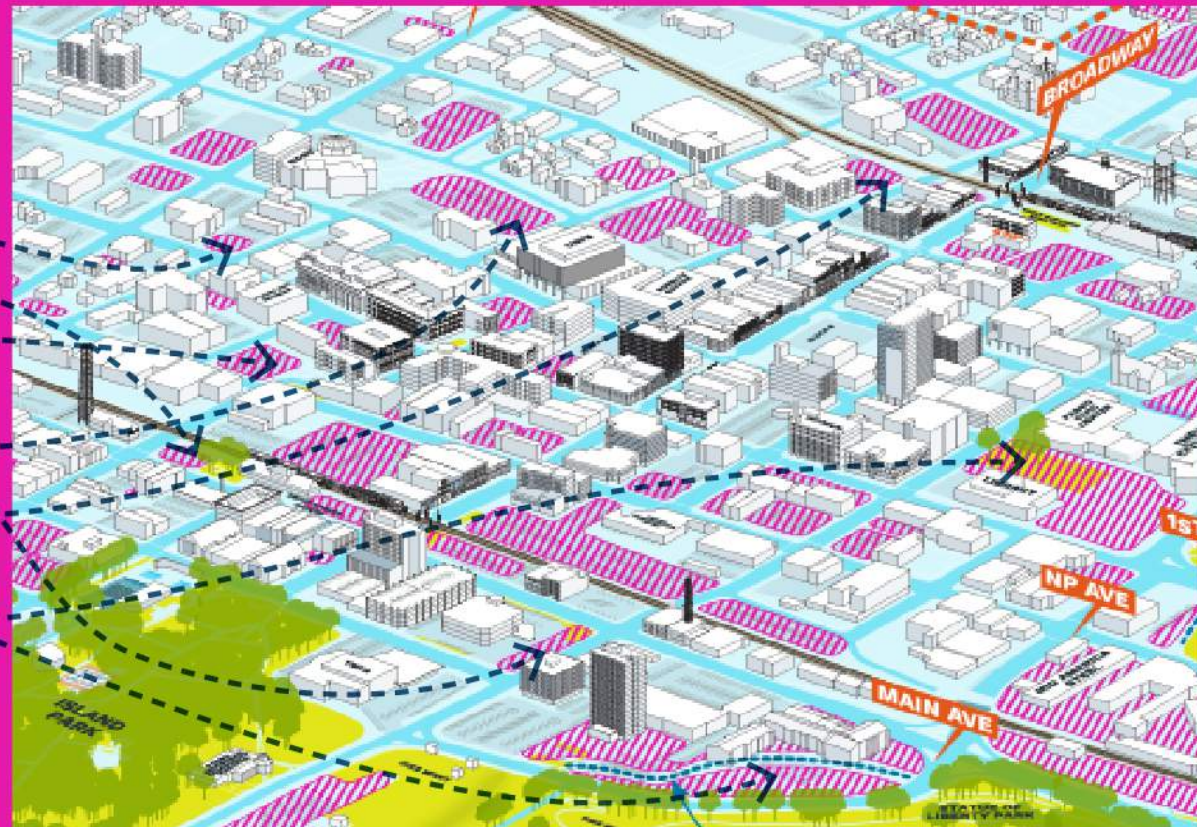

because **you told us**

What do you **LIKE** most living, working, or visiting Downtown?

TOP 3

DOWNTOWN RESIDENTS

The local **restaurants and bars**

The area is **walkable / bikeable**

The community **social life** (events, programming, etc.)

NON-DOWNTOWN RESIDENTS

The local **restaurants and bars**

The community **social life** (events, programming, etc.)

The **walkability**

DOWNTOWN EMPLOYEES

The **walkability**

The **lunch options** nearby

Access to Downtown **events and programming**



WHAT IF?

we made **complete streets** common place?

...to improve safety and offer transportation choice for those who opt to walk, bike or use transit as well as drive

If we're talking about streets, it's important to put **safety first**. Improve pedestrian safety – especially at wide crossings – like Main Avenue. Today, you have to walk across nearly 60 feet of space (and 20,000 cars a day) to access businesses on Main. We can make this safer for everyone.

Main Ave - EXISTING

Looking East

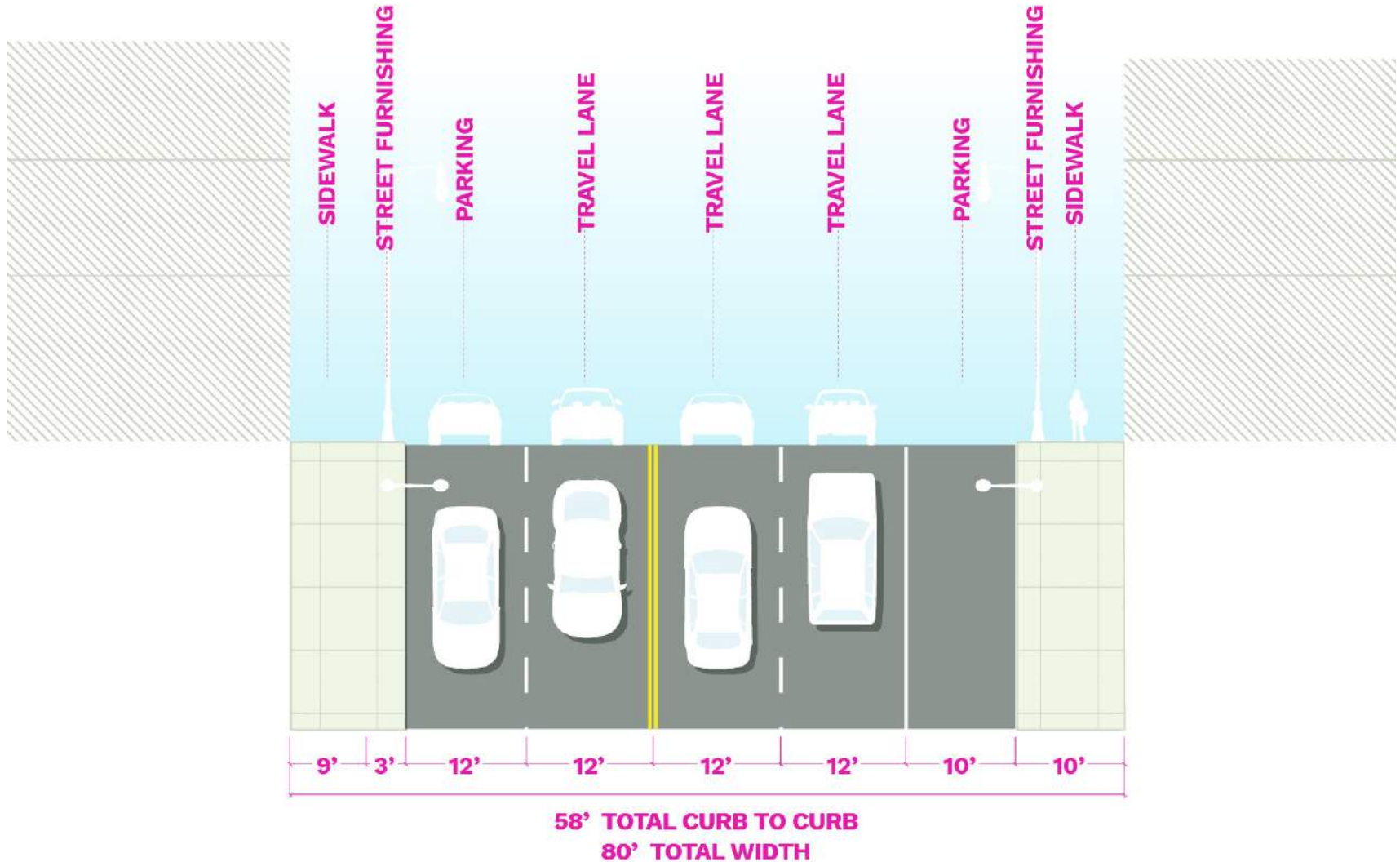



We should identify **key streets for bicycles Downtown.** With more bike lanes comes more people wanting to ride bikes and less cars on the road.

Proposed Bike Network

Source: Sam Schwartz

- EXISTING OFF-STREET TRAILS
- EXISTING ON-STREET BIKE LANES
- - - INFILL ON-STREET BIKE LANES
- EXTENSION OF ON-STREET NETWORK
- BIKE FACILITY THROUGH INTERSECTION
- TRAILHEAD



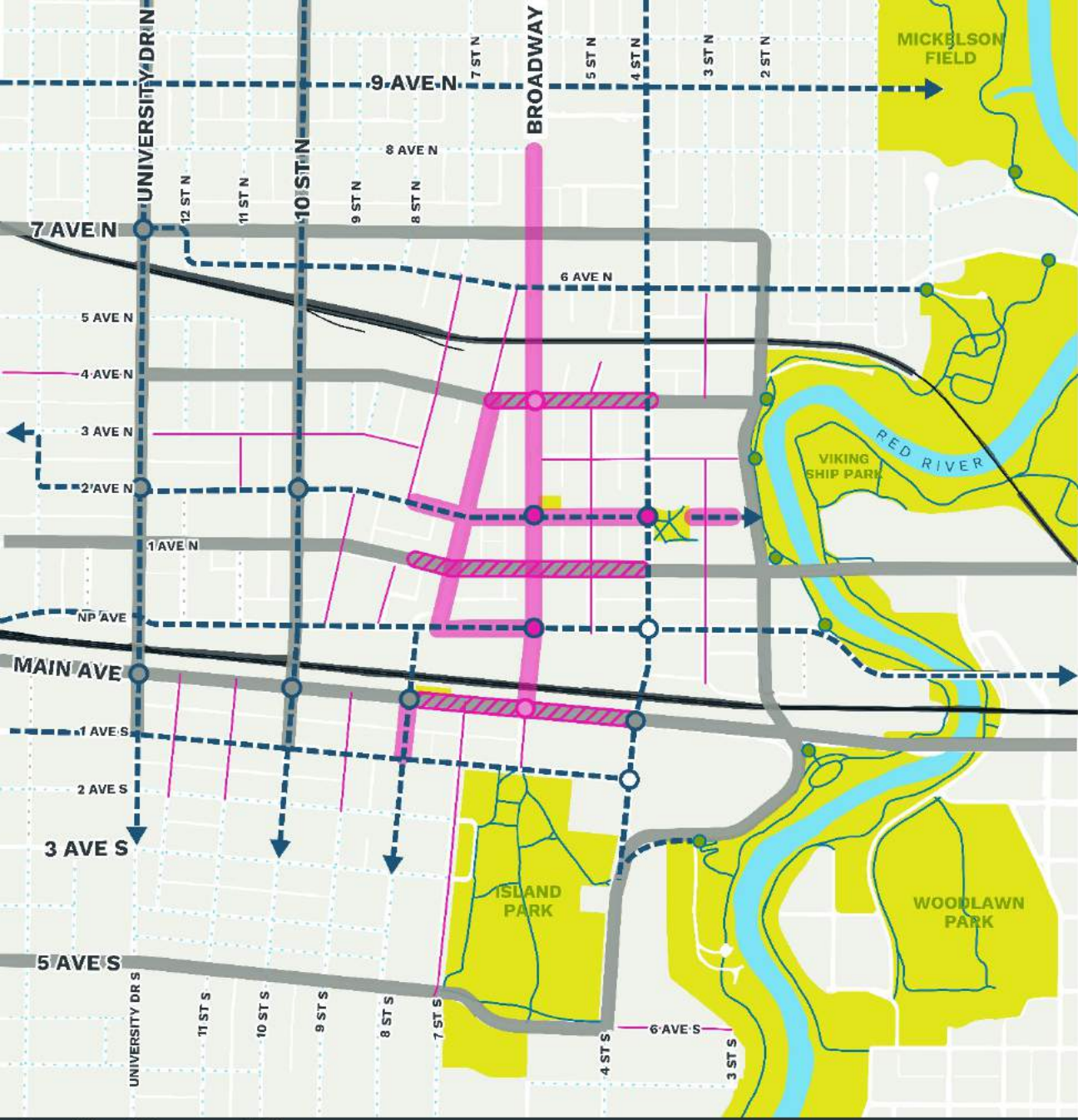

An not all streets are good for bikes. Some need to be designed to handle traffic.

Downtown needs a clear **street hierarchy that informs all reconstruction projects.**

Proposed Street Network

Source: Sam Schwartz

- EXISTING OFF-STREET TRAILS
- PEDESTRIAN ENHANCEMENT FOCUS
- VEHICLE FLOW FOCUS
- BICYCLE CONNECTION
- INTERSECTION ENHANCEMENT
- LOCAL / FLEX STREETS
- NEIGHBORHOOD CHARACTER SLOW STREETS
- INTERSECTION ENHANCEMENT
- EXISTING TRAILHEADS



Example - 2nd Avenue is a critical east-west corridor that connects NDSU facilities with City Hall, the Library and River. For these reasons it's a great street for bikes.

TODAY

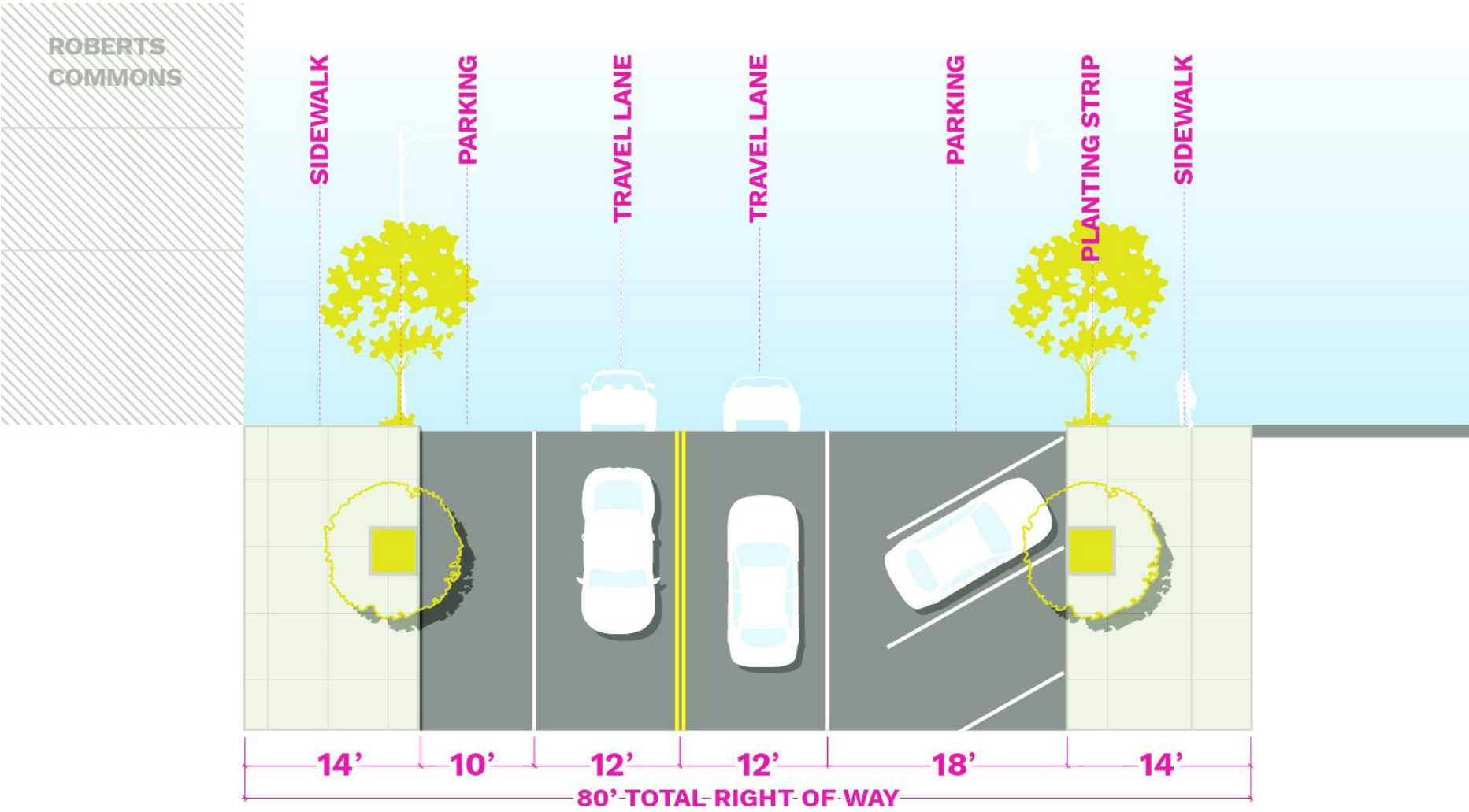

The opportunity is to make this a bike-friendly street and improve pedestrian safety –create safe bike lanes, wider sidewalks and more greening

RECONSTRUCTION

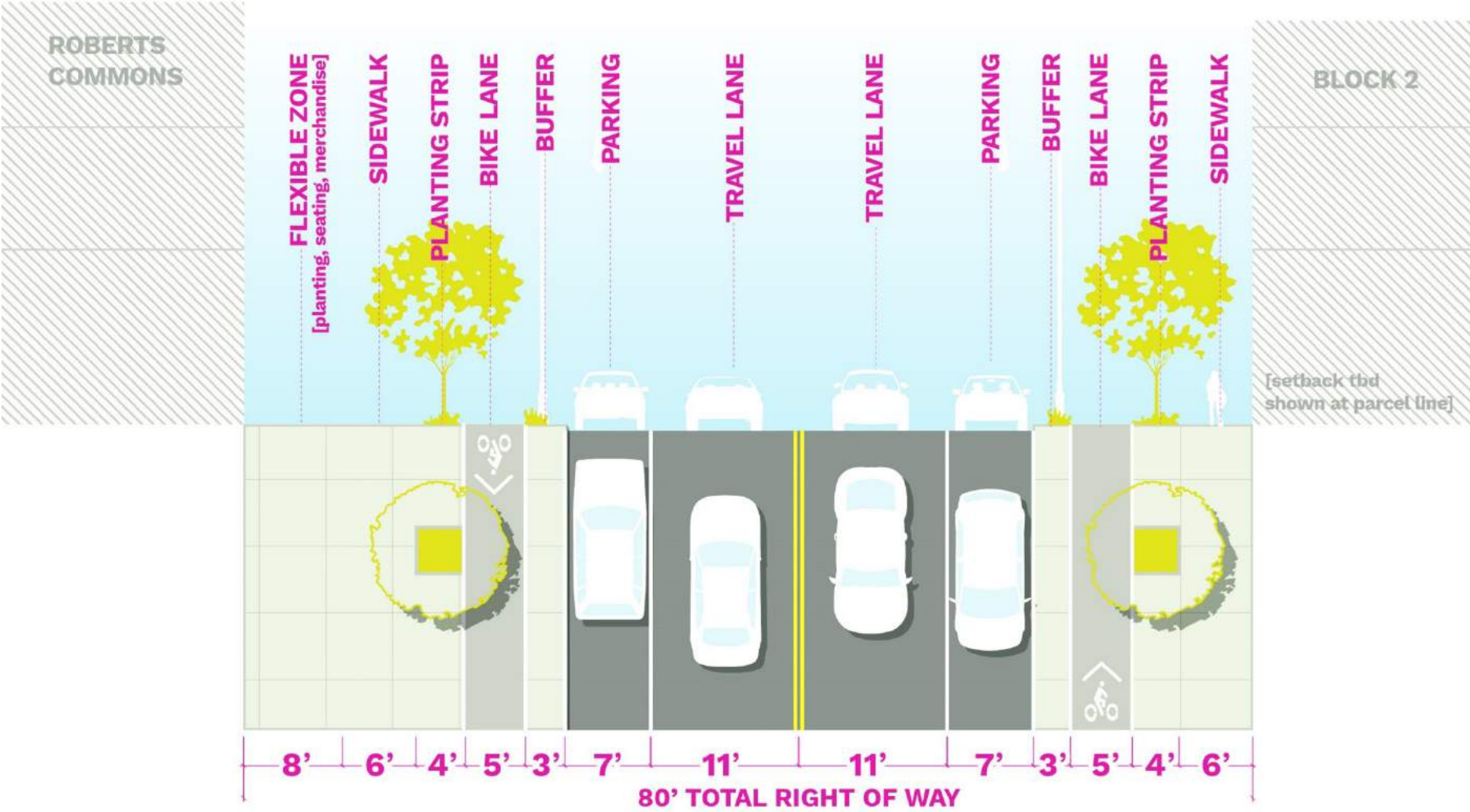

4th Avenue, however, is an opportunity to increase street parking and ensure it is a safe street for pedestrians

4th Ave N - EXISTING

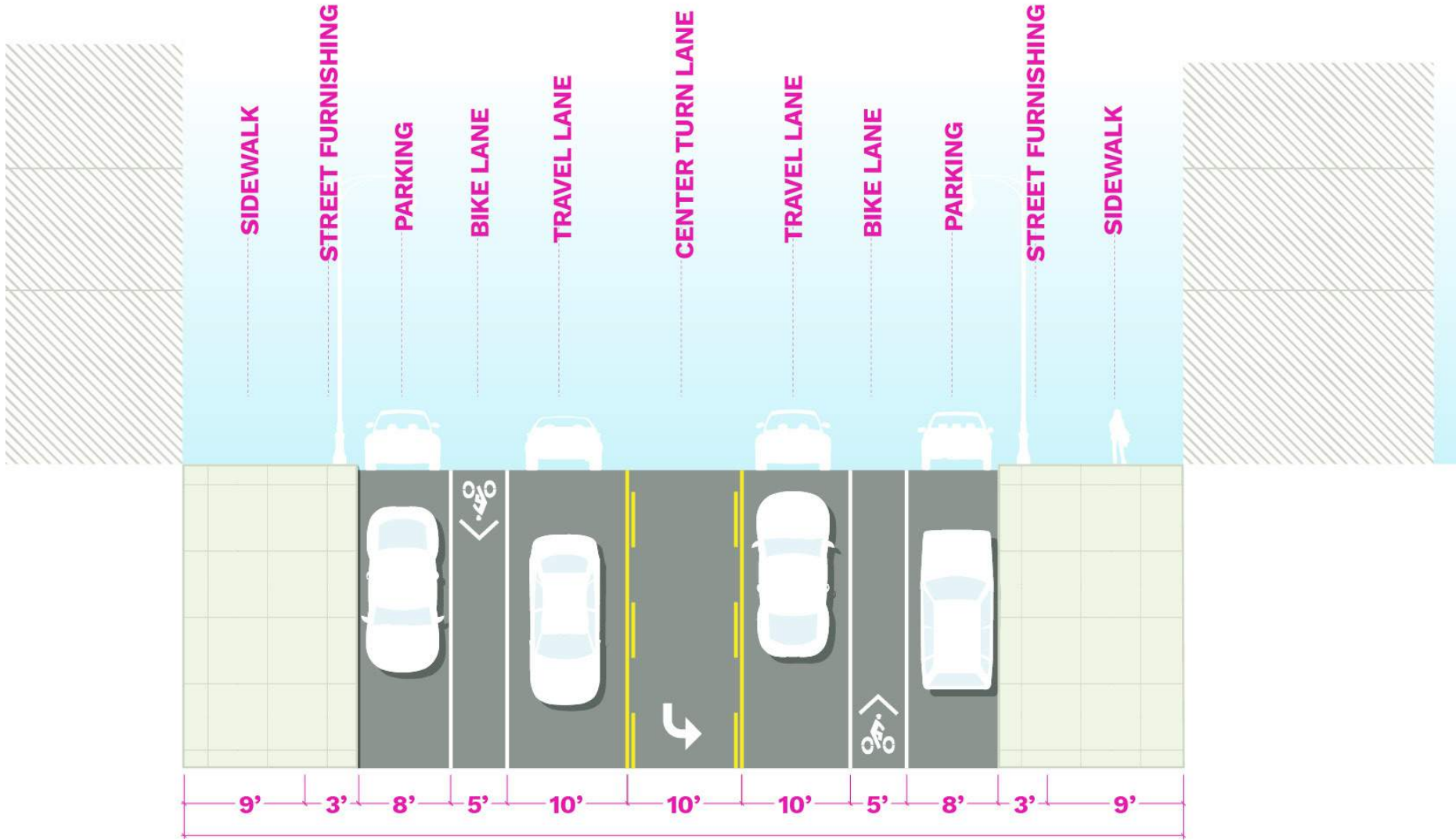

56' CURB TO CURB

80' TOTAL WIDTH

Here a bike lane is removed and parking increased

PROPOSED Section – 4th Avenue N

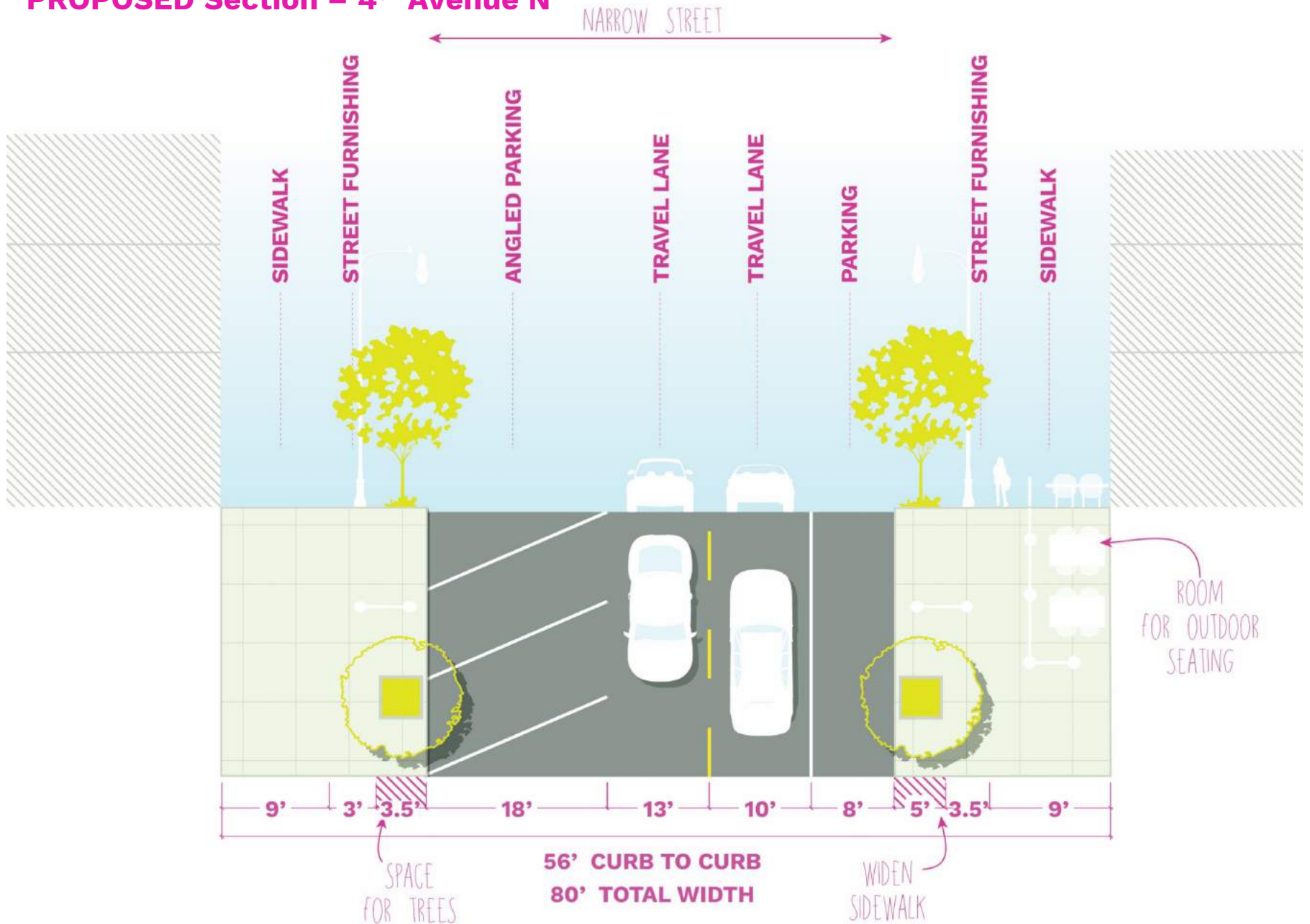

because **you told us**

What do you **DISLIKE** most living, working, or visiting Downtown?

TOP 3

DOWNTOWN RESIDENTS

The **nuisance issues** (noise, drunken behavior, etc.)

It's difficult to find **parking**

I have concerns about public **safety**

NON-DOWNTOWN RESIDENTS

It's difficult to find **parking**

The lack of **affordable housing**

Other

DOWNTOWN EMPLOYEES

The lack of **parking**

I have concerns about **safety** in the area

Other



WHAT IF?

we **managed parking**
efficiently to provide
opportunities for more
development and activity?

...to better meet the parking needs of all users Downtown

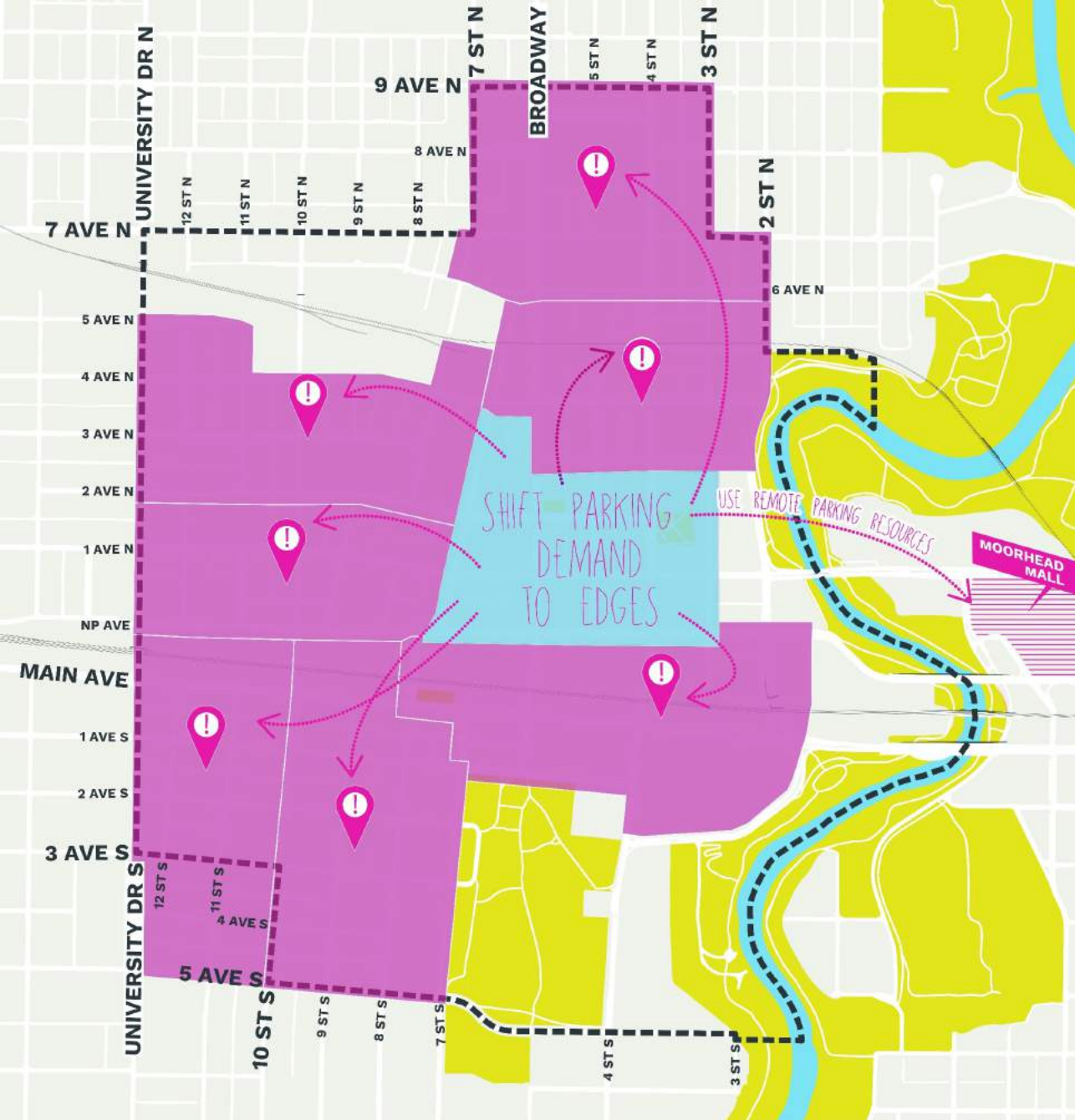

Here's the issue – everyone wants to park in the blue area. As there is more development, more of Downtown will have a deficit of parking spaces. We can't build parking lots and garages to solve this problem. We have to manage parking for all of Downtown. How can we do that? It's a number of things working together...



Some initial ideas:

Make it easy to park once by improving wayfinding and lighting to ensure it feels safe walking from any parking spot Downtown. Also, upgrade the look & feel of parking lots.

Encourage sharing parking spaces (employees during the day, residents at night) to maximize the use of existing parking spaces.

Change the parking rates, time restrictions, and penalties to help customers find convenient parking. Increase rates in areas with a lot of demand and lower them in other areas.

Advocate for metered parking: Encourage the State to eliminate the ban on metered parking, and bring meters Downtown. Use collected revenue to improve Downtown Streets.



In addition we need to work closely with employers:

Work with local employers to incentivize alternative modes of commute: Encourage willing employers to offer employees transportation options including

- Potential parking cash out program or discounted transit pass
- Discounted bike share
- Reserved spaces in high-demand garages for carpooling employees
- Offering a guaranteed ride home for employees who take transit

Make Link FM more desirable and useful for employees: Adjust the service area and frequency to connect employees with available parking



But addressing parking is also about encouraging different ways to get around for those that choose to ride their bikes or take transit:

Build out the bike share system in and around

Downtown: and include access to the program from nearby neighborhoods

Enhance local transit

stops: Increase the visibility and improve the quality of bus stops; improve main pathways to the GTC, and better integrate the station into the fabric of Downtown.



And don't forget
Winter 😊

**Lengthen the season for
alternative modes:**

Prioritize investment in bike
lane snow clearing, sidewalk
clearing and weather-
appropriate transit amenities



Bus stop & winter warming hut!



Taking care of bike lanes in the winter: Montreal, credit Bartek Komorowski

WHAT WE WANT YOU TO DO...

Help us decide the best way to balance parking and development downtown



Look at 5 different scenarios for re-developing a parking lot and choose your top 2, weighing these different factors in each

- **WALKABILITY**
- **CIRCULATION**
- **NUMBER OF SQFT**
- **VALUE OF SPACES**
- **INCREASED TAX REVENUE FROM DEVELOPMENT VS PARKING**
- **INCREASED TAX BURDEN TO SUPPORT PARKING GARAGE**

At the last open house, you played “FargoCraft” to identify potential open space improvements.

because **you told us**

You want to connect with the River!

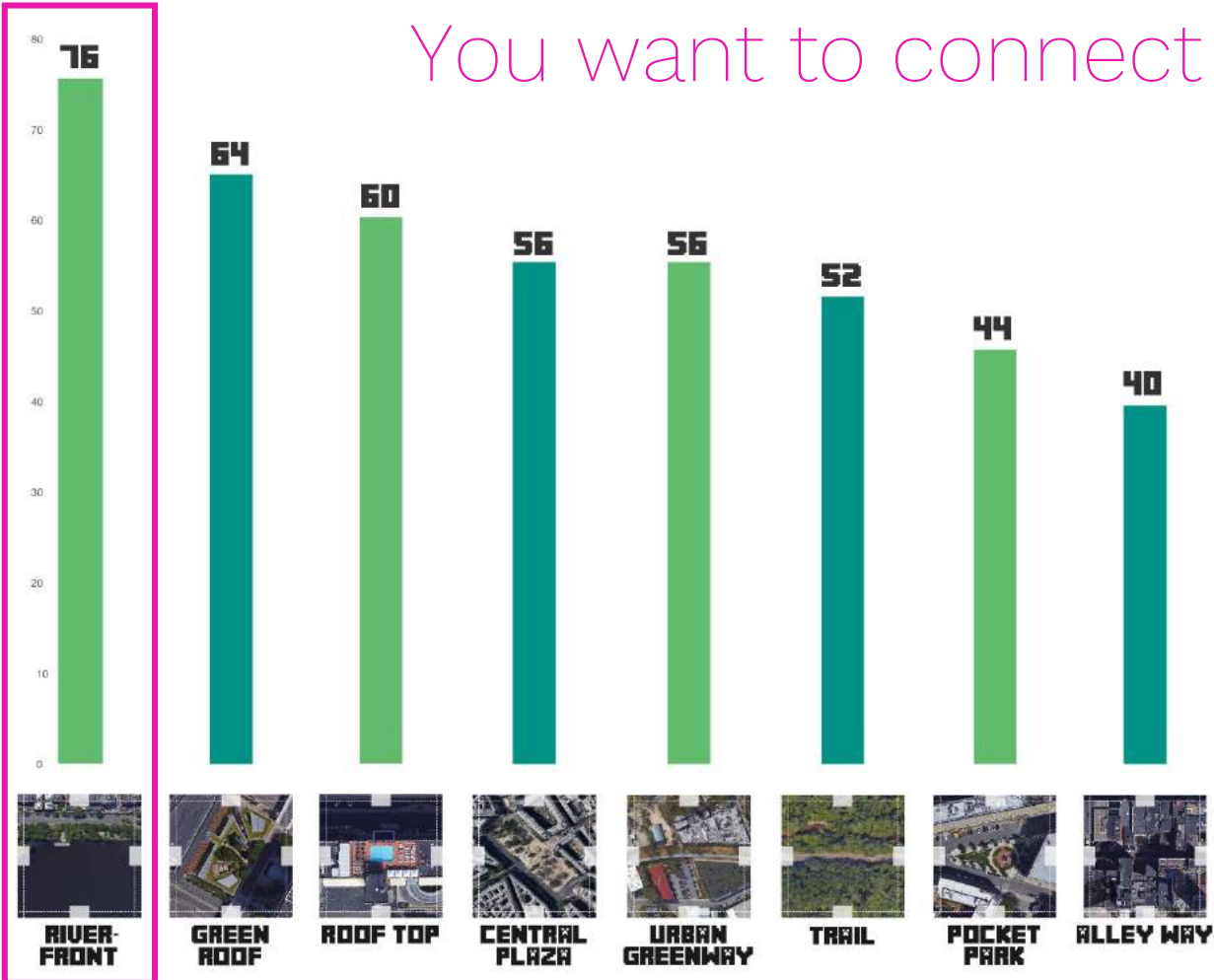

FARGO-CRAFT:
Landscape
Types



WHAT IF?

we fully **activated the riverfront** and created one downtown for two cities?

...to create stronger connections between Downtown Fargo and Moorhead and, better activate the Red River

THAT SOUNDS GREAT...
BUT HOW CAN WE
DO IT?

Some initial ideas:

Redevelop key properties along the River: Provide more housing and density along the River; include public amenities and access to the river front



THAT SOUNDS GREAT...
BUT HOW CAN WE
DO IT?

Some initial ideas:

Reconnect and activate the wall: Focus on physical connections

- Design spaces on both sides of the flood wall to help people navigate this barrier
- Integrate public art and programming for nearby open spaces
- Pursue a bridge aligned with 2nd Ave





FESTIVALS



KAYAK

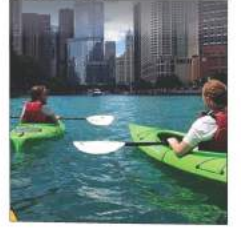

CONCERTS



BOAT TOUR



EXT. DINING



The top five programs selected by participants for Riverfront were festivals, concerts, exterior dining, kayaks, and boat tours.

Riverfront

Source: BLD

-  **RIVERFRONT TRAIL**
-  **POTENTIAL DEVELOPMENT**
-  **EXISTING RIVERFRONT PARK**
-  **OPPORTUNITY SITES**



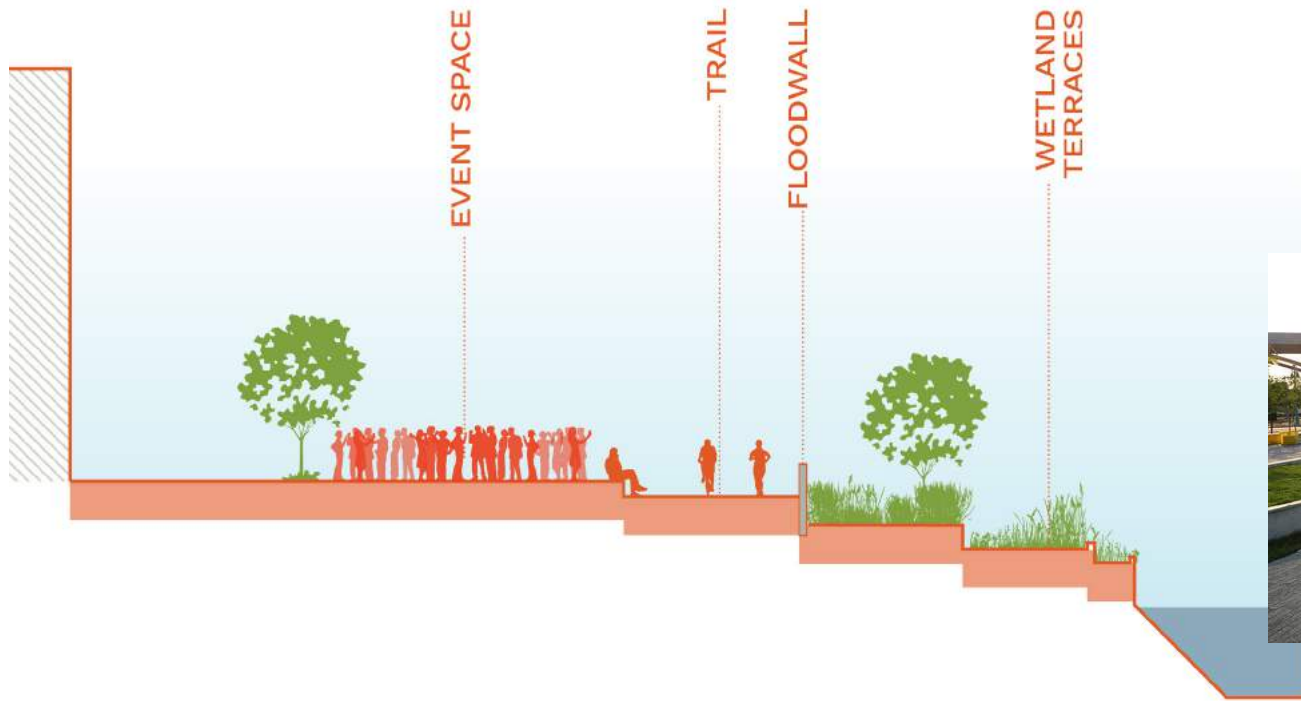

Here's an option to create a plaza that steps toward the River where possible

Riverfront Plaza

NEW DEVELOPMENT+TRAIL+EVENT SPACE

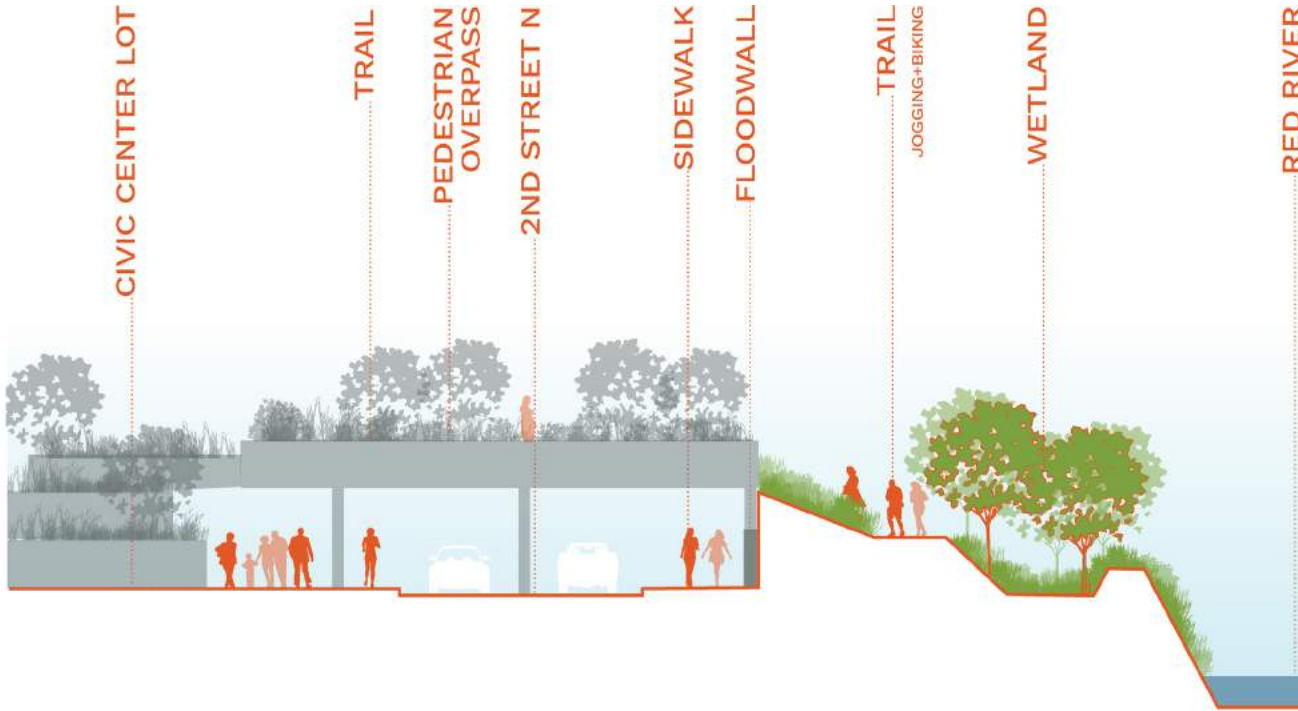

In other locations we need to look at other ways to “bridge” over the wall (and adjacent streets) – how about this as an idea?

Riverfront

CONTINUOUS ELEVATED
TRAIL+LAND BRIDGE+PLAZA

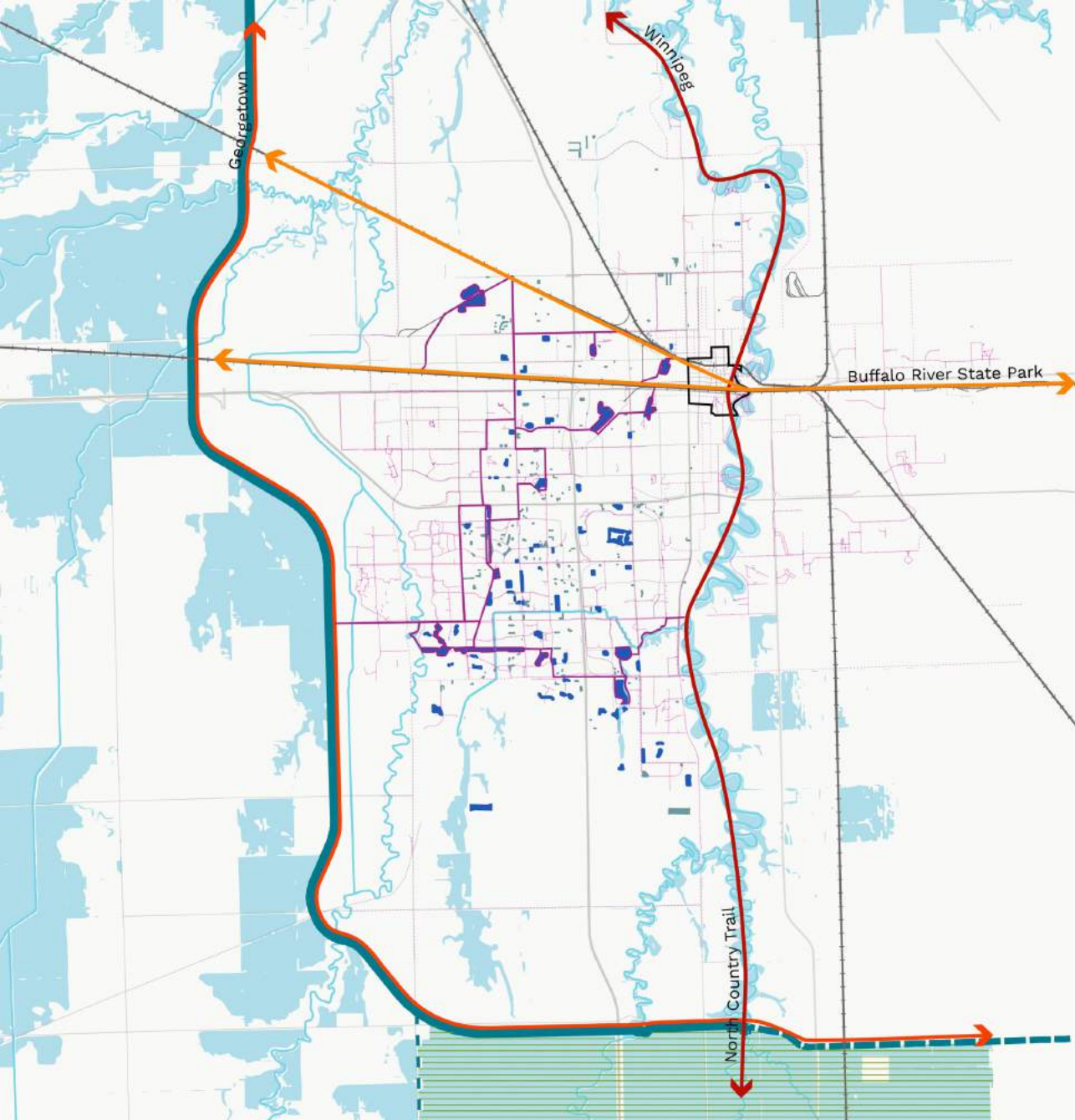

Create a multi-use trail on both sides of the River and connect to regional trails created with the Diversion

Regional Trail Network

Source: BLD

- **RIVERFRONT TRAIL**
- **URBAN GREENWAY**
- **DIVERSION TRAIL**
- **BIKE INFRASTRUCTURE**
- **TRAIN TRACKS**
- **RIVER**
- **DIVERSION CENTERLINE**
- - - **TIEBACK EMBANKMENT**
- . . . **OVERFLOW EMBANKMENT**
- **PUBLIC DETENTION BASIN**
- **PRIVATE DETENTION BASIN**
- ▨ **PROPOSED NATURE RESERVE**

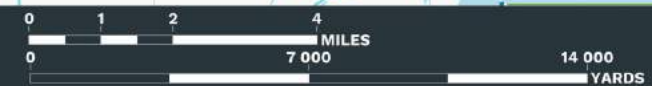

To connect to a regional trail system, we need to create greenspace. There are opportunities adjacent to the rail lines to do this.

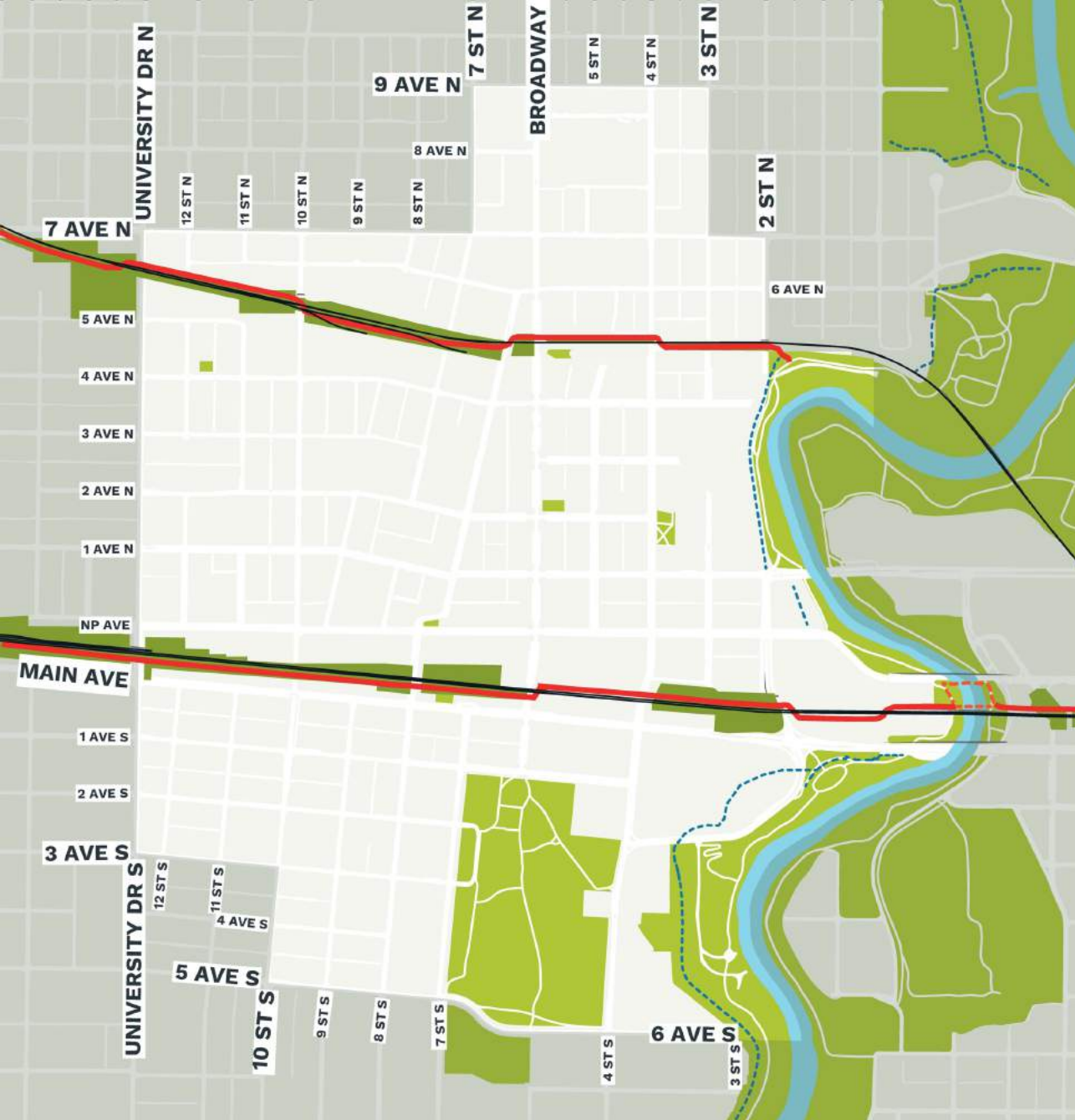

Urban Greenway

Source: BLD

- RAILROAD
- GREENWAY TRAIL
- - - PROPOSED CONNECTION
- OPPORTUNITY CORRIDOR

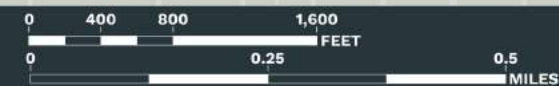

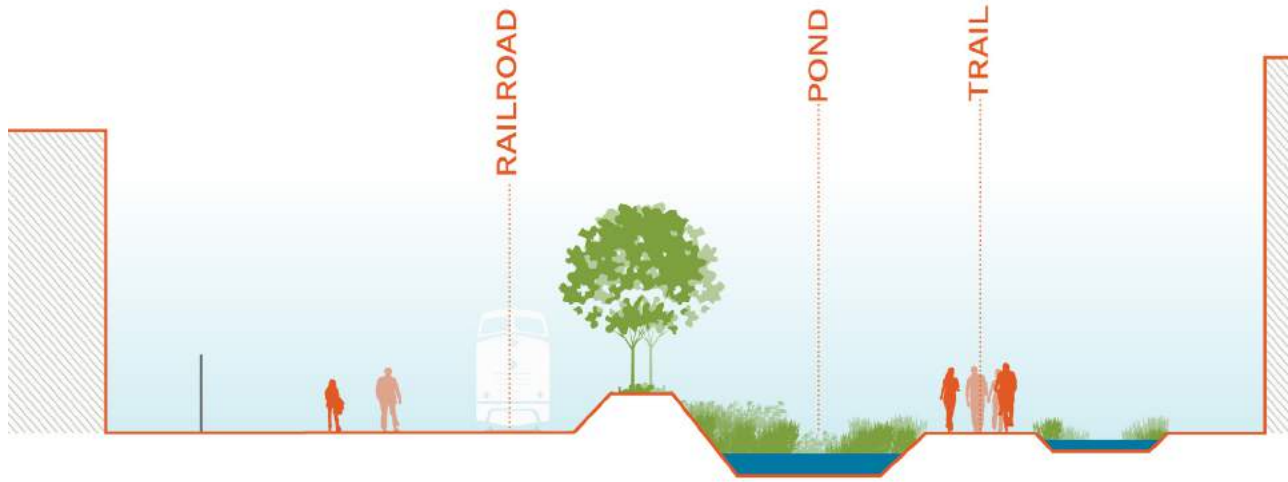

The greenway could make use of unused space adjacent to the rail to connect trails

Urban Greenway

RAIL-SIDE TRAIL
+DETENTION/RETENTION PONDS



WHAT IF?

downtown had many **places dedicated to play** and designed to **bring people together**, year-round?

...to develop a system of connected and programmed green spaces designed for a range of ages and interests and, to make Fargo a model for blue/green infrastructure

And...what if we also created open spaces that **act as infrastructure?**

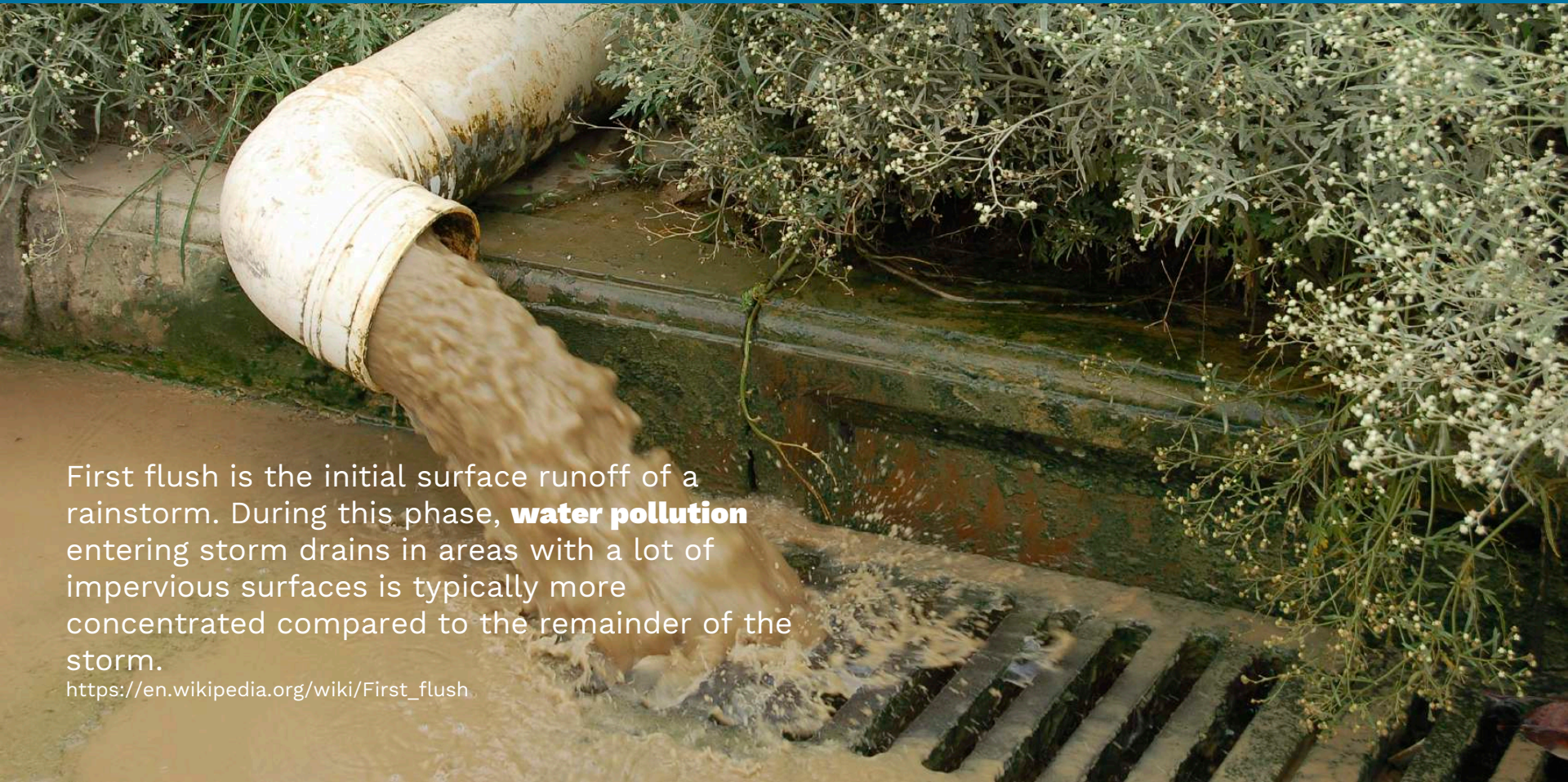

First flush is the initial surface runoff of a rainstorm. During this phase, **water pollution** entering storm drains in areas with a lot of impervious surfaces is typically more concentrated compared to the remainder of the storm.

https://en.wikipedia.org/wiki/First_flush

THAT SOUNDS GREAT...
BUT HOW CAN WE
DO IT?

Some initial ideas:

Make the Library home base for welcoming families to Downtown:

Program the City Hall Plaza to encourage more regional visitors and create programming for families with children and students under 21

Develop more all-weather venues and events: (like Frostival!)



Integrate greening throughout Downtown

and seek to retain rainwater before it rushes into the existing pipes. This **Downtown open space network** could stitch together alleys, small parks, the Block 9 Plaza, City Hall Plaza, and the River



- ALLEYWAYS
- URBAN GREENWAY
- GREENWAY OPPORTUNITY
- POTENTIAL GREENROOFS
- GREEN STREETS
- BIKE INFRASTRUCTURE
- OPPORTUNITY SITES
- RIVERFRONT ACCESS
- RIVERFRONT
- FLOODWALL

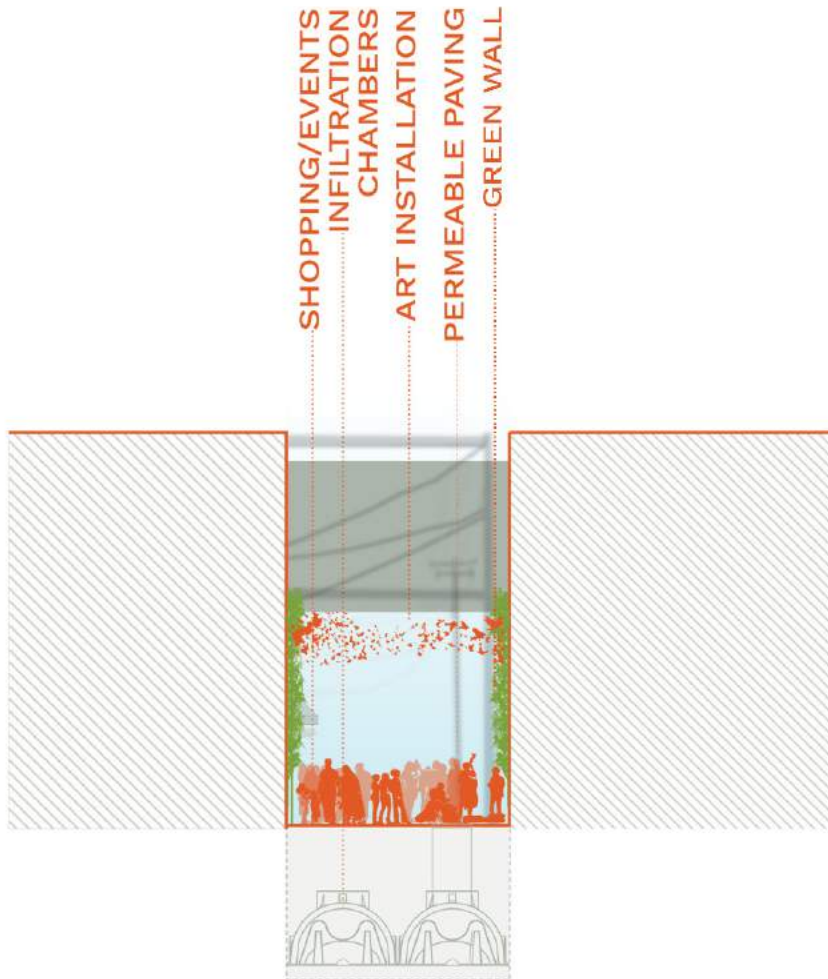

Alleys, when rebuilt, can serve an important purpose for stormwater management and greening



Alleyways

COMMUNITY PROGRAMS+INTEGRATED
STOMWATER MANAGEMENT+GREEN
WALL



Here is an example of an alley improved for pedestrians and designed to retain stormwater

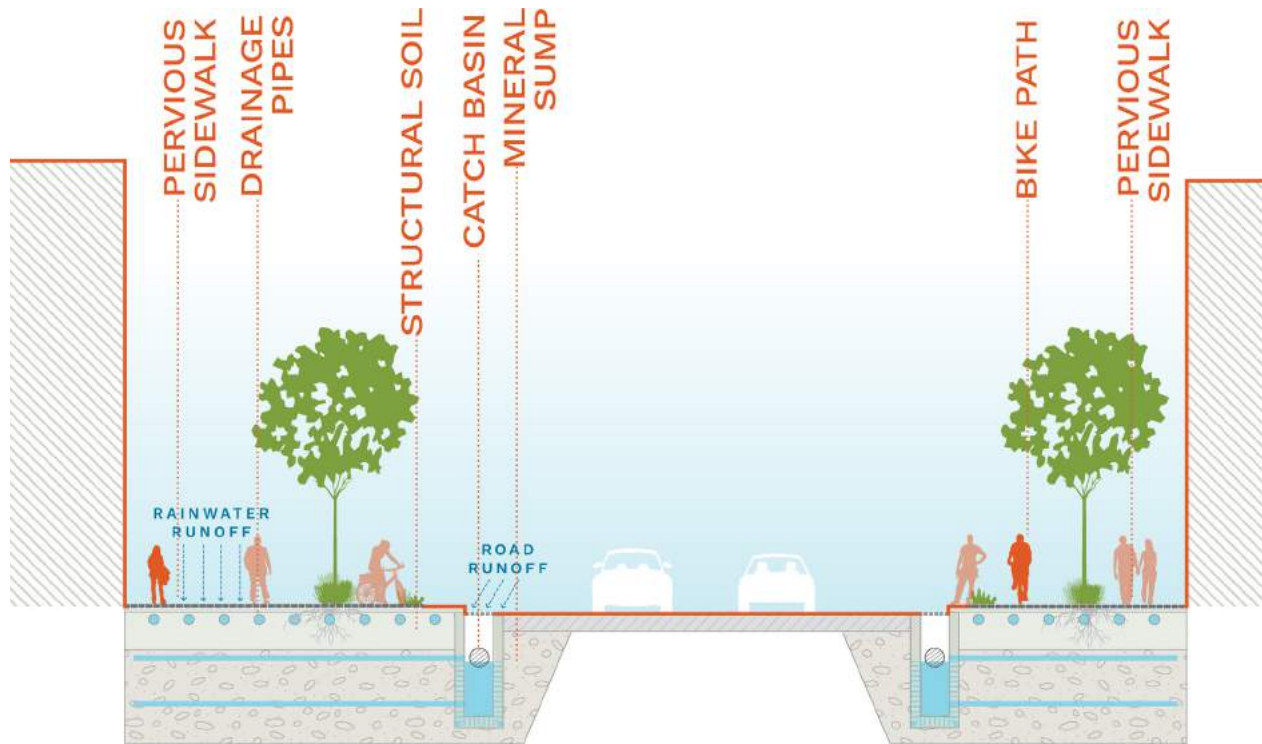

Streets too can provide some space for water retention when reconstructed. The “Mineral Sumps” can hold water which can be used for trees and landscaping

Streetscape

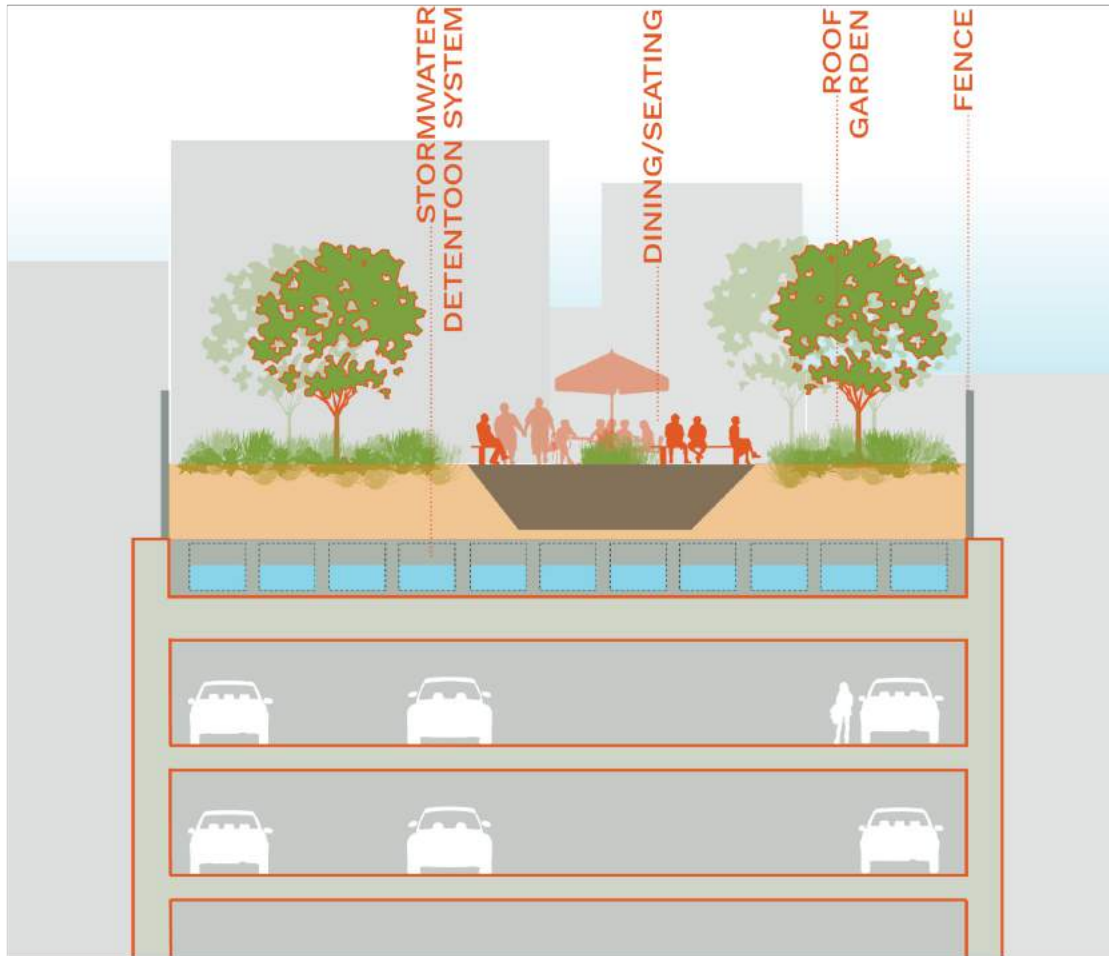

Green Roof

And don't forget about rooftops!

Consider roof-top retention as a means of capturing water before it hits the street. Stored water can be used for irrigation and fire suppression.



WHAT IF?

downtown becomes a
model for **inclusive
growth & development?**

...to recognize that poverty and the risk of homelessness render some community members vulnerable and that quality services are available where they are most needed



Some initial ideas:

Education and outreach: Expand Homelessness 101 trainings and build awareness of the Downtown service network

Adapt to meet new needs: Broaden service delivery through new programs and facilities like a day shelter or place for homeless teens

Housing First: Work with affordable and transitional housing providers to identify development opportunities that will serve low-income families and individuals

Help create pathways to work: Connect those who are able to work with job training and transit options that bring available jobs within reach

What do you think? We need your help. The open house is set up around key topics like housing, transportation and green space. Let us know what you think.

WHAT WE WANT YOU TO DO...

If Downtown was able to generate more money for improvements, what would you do with it?
(Choose only 3)



**HELP PRESERVE
HOUSING
AFFORDABILITY**



**HELP TO ENSURE
THAT LOCALLY
BUSINESSES & ARTS
ORGANIZATIONS
REMAIN DOWNTOWN**



**CREATE MORE
PARK SPACE
DOWNTOWN**



**CREATE MORE
PUBLIC ART &
HELP FINANCE A
PERFORMING
ARTS CENTER**



**MAKE BETTER
CONNECTIONS TO
THE RED RIVER &
CREATE A
REGIONAL TRAIL
SYSTEM**



**IMPROVE
LOCAL
SIDEWALKS &
STREETS**



**HELP REDUCE
FLOODING FROM
RAIN STORMS**



**PLANT MORE
TREES**



**EXPAND
TRANSIT &
BIKE SHARE**



**FUND
CLEANING &
SAFETY
INITIATIVES**

THANK YOU! and **stay warm!**

